

COMPANY PROFILE

**Assuring Codes
& Keen Design**

Since 2004

www.ackdconsult.com

Riyadh, Saudi Arabia

ACKD

TABLE OF CONTENT

01 Company Profile	02 Design Portfolio	03 AOR Services	04 Interior Design
05 Supervision & Project Management	06 Fire & Life Safety Portfolio	07 Urban Planning	08 Surveying

INTRODUCTION

Assuring Codes & Keen Design

ACKD Consult is a leading Saudi Consultancy firm established in 2004, The head office is in Riyadh and the owner and General Manager is Eng. Abdullah al- Bishr who have a consultant degree for SCE.

ACKD Consult sets strong professional standards, and high ethical values, and prides itself in having a professional, coherent, highly educated, and experienced team working with customers and clients to understand their requirements and provide them with the best professional services and sustainable economic solutions within the required timeframes and deadlines.

The firm has also collaborated with several educational and governmental institutions for seminars and workshops to spread technical knowledge, ideas, and values as well as to nurture and promote the young generation to help them to be better prepared for their careers in line with the ongoing renaissance and development in the Kingdom to attain the Saudi Vision 2030 and beyond.



INTRODUCTION

WE ARE

ACKD Consult is a multi-disciplinary consultancy firm specializing in AOR, Architecture, Fire Safety, Structural, and Interior design. We deliver our services to a host of local, regional and international clients. We give engineering solutions by adopting a pragmatic approach and applying innovative techniques.

THE ACRONYM

ACKD: Assuring Codes and Keen Design

Assuring Codes (The "Science"): We ensure technical expertise, safety, and full regulatory compliance.

Keen Design (The "Art"): We deliver sharp, intelligent, and high-quality creative solutions.

Our Promise: A complete package that balances intelligent, creative design with technical reliability and safety.

COMMITMENT

We are committed to executing and furthering all engineering services, applying Saudi Building Code requirements (SBC), local & international technical associations, Authority having jurisdiction, and investment in human resource development & training.

ASSETS

Our most valuable asset is our team of driven industry experts who are equipped with high-level training and professional experience, making them among the best in their field. We are committed to their development and retention. Through investment in their continuous professional development, we are able to maintain a high level of delivery that our clients are accustomed to and expect from us. Through ongoing industry engagement and continuously evolving practices, we provide objective, expert guidance combined with functional specialist expertise to create a comprehensive and effective service.

INTRODUCTION

VISION

The corporate vision of ACKD Consult is that life and assets can only be effectively protected if experienced advice is provided in an unbiased and independent way.

Hence ACKD Consult has no special interests or financial ties with manufacturers, suppliers, contractors, or insurance brokers.

- > **ACKD** has an experience and professionally accredited staff.
- > **ACKD** provides Clients with sound professional services and deployment strategy in full consideration and awareness of local regulations and Culture.
- > **ACKD** invests in existing Client relations and explores possibilities to expand in new and emerging markets to ensure sustainability and growth.
- > **ACKD** offers employees an inspiring working environment and the opportunity to nurture and develop their technical and personal skills.

VALUES

ACKD Consult is committed to respecting and achieving the following values:

- > Quality & professionalism.
- > High ethical conduct and transparency
- > Quality & professionalism.
- > Utmost consideration and care for
- > Clients' needs.

"As people alive today, we must consider future generations: a clean environment is a human right like any other. It is, therefore, part of our responsibility towards others to ensure that the world we pass on is as healthy, if not healthier than we found it."

(The Dalai Lama)

INTRODUCTION

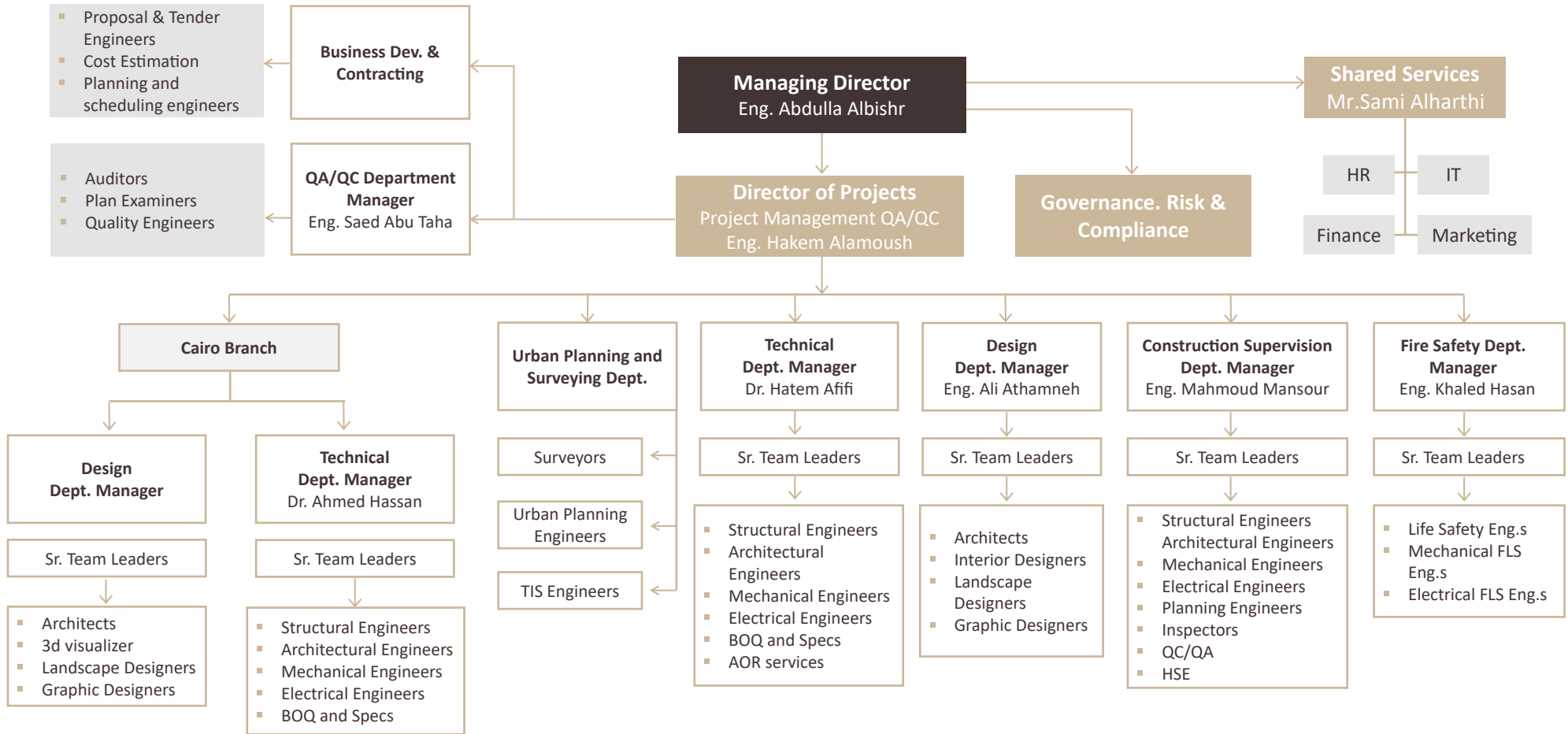



WE ARE SPECIALIZED AT:

A. Full Design Services

ACKD Consult provide the following Design Services

- > Full Structural, Architectural, and MEP design services from Concept through schematic to detailed design and issuance of IFC drawings. Landscape drawings. Provide design review and approval. Compliance with local and international life and safety regulations.
- > Cost estimate and analysis.
- > Preparing tender documents.
- > Government presentation and approvals.

C. Interior design - ID

B. AOR SERVICES

ACKD Consult has been providing Architect of Record service (AOR) for many years including but are not limited to the following:

- > Co-ordination with the statutory authorities and service providers such as Riyadh Municipality, Jeddah Municipality, Saudi Civil
- > Defense, Modon, SEC, NWC, and telecom service providers
- > Prepare and manage the Statutory Authorities approval process from project inception to delivery.
- > Submit application for approvals early in the project's timeline, whenever possible.
- > Collaborative team effort to obtain the building permit and projects' handover and close-out.

WE ARE SPECIALIZED AT:

D. Building Information Modeling (BIM)

ACKD Consult provides BIM services to enable collaboration between all team members working on the project resulting in huge improvements in the efficiency of projects

- > Potential problems are identified prior to the start of construction
- > Optimization of processes using 3D models
- > Improve Scheduling efficiency
- > Construction Automation
- > Increased worker safety

E. Site Supervision

ACKD Consult has been providing Site Supervision services on several projects including but not limited to the following:

- > Permanent and periodic site supervision by all disciplines according to project requirements and needs.
- > Ensure Compliance with Project's specifications and SBC Codes & standards.
- > Follow-up on statutory authorities' approval process and handover till project close-out and building occupancy.



WE ARE SPECIALIZED AT:

F. Fire and Life Safety Consulting

ACKD Consult is approved and certified as a fire protection consultant with:

- > Civil Defense
- > HCIS
- > MODON

We have a professional team in fire and life safety with full capability for work in FLS systems to protect life and property by applying local requirements & international codes and standards.

ACKD Consult prepares designs, reviews, and testing of fire safety systems according to the following local and international codes and standards:

- > Saudi Building Code (SBC)
- > National Fire Protection Association (NFPA)
- > Civil Defense Requirements.
- > SAF HCIS requirements.
- > Applicable fire safety requirements.



SECTORS – SERVICES

ACKD Consult provides engineering Services in the following types of Sectors

1

Entertainment

2

Industrial

3

**Commercial
buildings**

4

Residential

5

Educational

6

Military

7

**High rise
buildings**

8

**Infrastructure
Networks**

9

Transportation

10

Health Care

SECTORS – SERVICES

ACKD Consult provides engineering Services in the following types of Sectors

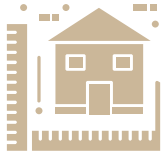

Design Review



Submit Deliver to AHJ



Design



Supervision



Technical Solution

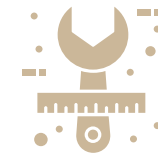

Testing

ACCREDITATIONS AND QUALIFICATIONS

ACKD Consult company has credits from many local and international Authority agencies, here is some samples:



Saudi Aramco



Ministry of Culture



Saudi Commission for Tourism & National Heritage



Ministry of Water & Electricity



Civil Defense



Saudi Industrial Property Authority



High Commission for Industrial Security



MARAFIQ



Ministry of Municipal and Rural Affairs



Ministry of Housing



Saudi Ports Authorities



Saudi Electricity company



Royal Commission for Jubail & Yanbou



Ministry of Health



Presidency of Meteorology and Environment Protection



SABIC Company

TARGET CLIENTS



SELECTIVE CLIENTS



APPROVAL CERTIFICATES ISO CERTIFICATES

2/1

شهادة
تصنيف مقدمي خدمات المدن
لمنح وزارة البنية التحتية والإسكان شهادة تصنيف مقدمي الخدمات
الشركة: اكد للاستشارات الهندسية

رقم الوثيقة	تاريخ إصدار السجل التجاري / الترخيص	إسم الشركة	نوع الشهادة	رقم السجل
5310000332	24/09/2016	شركة صالح بن عبدالله آل مكتوم	إدارة مشاريع بحرينية	150000

رقم الشهادة	تاريخ الإصدار	درجة التقييم الإجمالي	درجة التقييم الفرعي
2024010811	01/10/2024	A+	70.5

الشركة الهندسية

تصنيف مقدمي خدمات المدن

01/10/2024

www.ackdconsult.com

MOMRA Classification (First Degree)

CERTIFICATE

This is to certify that the Environmental Management System of

ACKD CONSULT COMPANY
C.R. (1010425922)

47th Floor, Makkah Road, Jeddah, Saudi Arabia
Date: 10/10/2024, Validity: 365 Days

has been awarded and found to conform to the requirements of

ISO 14001:2015

The Certificate is valid for the following scope:
General Engineering, Consultancy Services (Design, Design review and Site Supervision), Fire and Life Safety Consultancy Services, Consultancy and Environmental Studies, Energy Audit Services, Architect of Record (AOR) Services, Civil and Urban Planning, Information Systems, Surveying Services

Certificate No.: 10CQR1313
Registration Date: 24/01/2022
Issue Date: 24/01/2022
Expiry Date: 24/12/2024
Recertification Date: 24/12/2024

BOQR QUALITY ASSURANCE PVT. LTD.

Director

IAS IAF

ISO 14001:2015

CERTIFICATE

This is to certify that the Quality Management System of

ACKD CONSULT COMPANY
C.R. (1010425922)

47th Floor, Makkah Road, Jeddah, Saudi Arabia
Date: 10/10/2024, Validity: 365 Days

has been awarded and found to conform to the requirements of

ISO 9001:2015

The Certificate is valid for the following scope:
General Engineering, Consultancy Services (Design, Design review and Site Supervision), Fire and Life Safety Consultancy Services, Consultancy and Environmental Studies, Energy Audit Services, Architect of Record (AOR) Services, Civil and Urban Planning, Information Systems, Surveying Services

Certificate No.: 10CQR1313
Registration Date: 24/01/2022
Issue Date: 24/01/2022
Expiry Date: 24/12/2024
Recertification Date: 24/12/2024

BOQR QUALITY ASSURANCE PVT. LTD.

Director

IAS IAF

ISO 9001:2015

CERTIFICATE

This is to certify that the Occupational Health & Safety Management System of

ACKD CONSULT COMPANY
C.R. (1010425922)

47th Floor, Makkah Road, Jeddah, Saudi Arabia
Date: 10/10/2024, Validity: 365 Days

has been awarded and found to conform to the requirements of

ISO 45001:2018

The Certificate is valid for the following scope:
General Engineering, Consultancy Services (Design, Design review and Site Supervision), Fire and Life Safety Consultancy Services, Consultancy and Environmental Studies, Energy Audit Services, Architect of Record (AOR) Services, Civil and Urban Planning, Information Systems, Surveying Services

Certificate No.: 10CQR1314
Registration Date: 24/01/2022
Issue Date: 24/01/2022
Expiry Date: 24/12/2024
Recertification Date: 24/12/2024

BOQR QUALITY ASSURANCE PVT. LTD.

Director

IAS IAF

ISO 45001:2018

OUR PROJECTS

We have designed, supervised, and provided engineering services for more than 3231 projects all over KSA.

Geographic Locations of our projects in all over the Kingdom

01. Design Projects

02. Project Management Consultant (PMC)

03. Fire and life safety



THE THREE STAGES OF SERVICE

STAGE ONE Visioning & Planning

ACKD's approach is tailored to each project, but is guided by the our cornerstones of our company:

- > International expertise
- > Commercial astuteness
- > Integrity & professionalism
- > An "open book" policy

STAGE TWO Management & Design

We take a holistic approach to the development process, ensuring that the entire process is managed synergistically and efficiently from the project initiation stage right through to final completion.

We are the single point of contact and remain responsible for the entire development process up to final completion and operational handover.

STAGE THREE Supervision & Delivery

Supervision and delivery is the critical stage where design, technical and financial planning converge in action.

By managing the full life-cycle of a project, our service and delivery culture provides clients with an all encompassing solution. We are the single point of contact and remain responsible for the entire development process up to final completion and operational handover.

DETAILED SERVICES

ACKD's adopts a structured and disciplined development process. This provides our clients with the opportunity to examine and approve each phase of a project, ensuring their vision is achieved at every juncture. Development phases of a typical project include:

- Project Initiation
- Project Inception
- Concept Design
- Schematic Design
- Design Development
- Construction Documentation
- Tender and Award
- Construction
- Project completion, Occupation and Handover

STAGE ONE**Visioning & Planning**

During visioning and planning we focus the ambitions of our client-partners through creative visioning and masterplanning coupled with an informed, robust financial strategy.

Stage One Services

- Site analysis
- EIA
- Project visioning
- Financial viability
- Traffic Studies
- Land surveying
- Market research
- Cultural relevance
- Identify project team
- Project design brief
- Masterplan design
- Asset mix
- Plot development
- Outline brand concept
- Outline urban concept

STAGE TWO**Management & Design**

At Mirage we believe that exceptionally planned, designed and delivered destinations, relevant to their market, can significantly transform economies and environments for the better.

The management and design stage ensures a deep collaboration and coordination between all design and development disciplines.

Stage Two Services

- Development management
- Project management
- Programme management
- Design management
- Full suite of design services
- Cost management
- Commercial management
- Early procurement
- Supply chain assessment
- Logistics assessment

STAGE THREE**Supervision & Delivery**

Through supervision, management and creative direction of the contracting, build and construction period, we deliver project success. We are custodians of the design intent and carefully orchestrate every detail to mirror the approved design. We constantly strive to push the boundaries in order to turn extraordinary visions into reality.

Stage Three Services

- Operator liaison
- Cost management
- Design management
- Procurement
- Development management
- Programme management
- Security
- Completion certificate
- Client liaison
- Project management
- Health and safety
- Snagging and defects
- Handover
- Defects liability period
- Site supervision
- Tendering
- Commercial management
- Auditing
- Negotiation

02

Design Portfolio

[BACK TO
TABLE OF CONTENT](#)



Anan Real Estate Residential Tower

PROJECT COMPONENTS

3 basements, 27 floor levels
30 keys residential Apartment
Multi F&B experiences

Land Area: 900 m²
Total BUA: 8,000 m²

AREAS OF EXPERTISE
Architecture & Engineering Design,
Construction Supervision

www.ackdconsult.com

Riyadh, Saudi Arabia

ACKD



www.ackdconsult.com

Riyadh, Saudi Arabia

Anan Real Estate Residential Tower

ACKD



Sahafa Tower

PROJECT COMPONENTS

Land area = 1800 m²

Total built up area = 25000 m²

Number of stories = 30 stories

AREAS OF EXPERTISE

Architecture & Engineering Design,
Construction Supervision

www.ackdconsult.com

Riyadh, Saudi Arabia

ACKD



Al-Sahafa Tower

PROJECT COMPONENTS

Land Area : 900 m2

www.ackdconsult.com

Riyadh, Saudi Arabia

ACKD

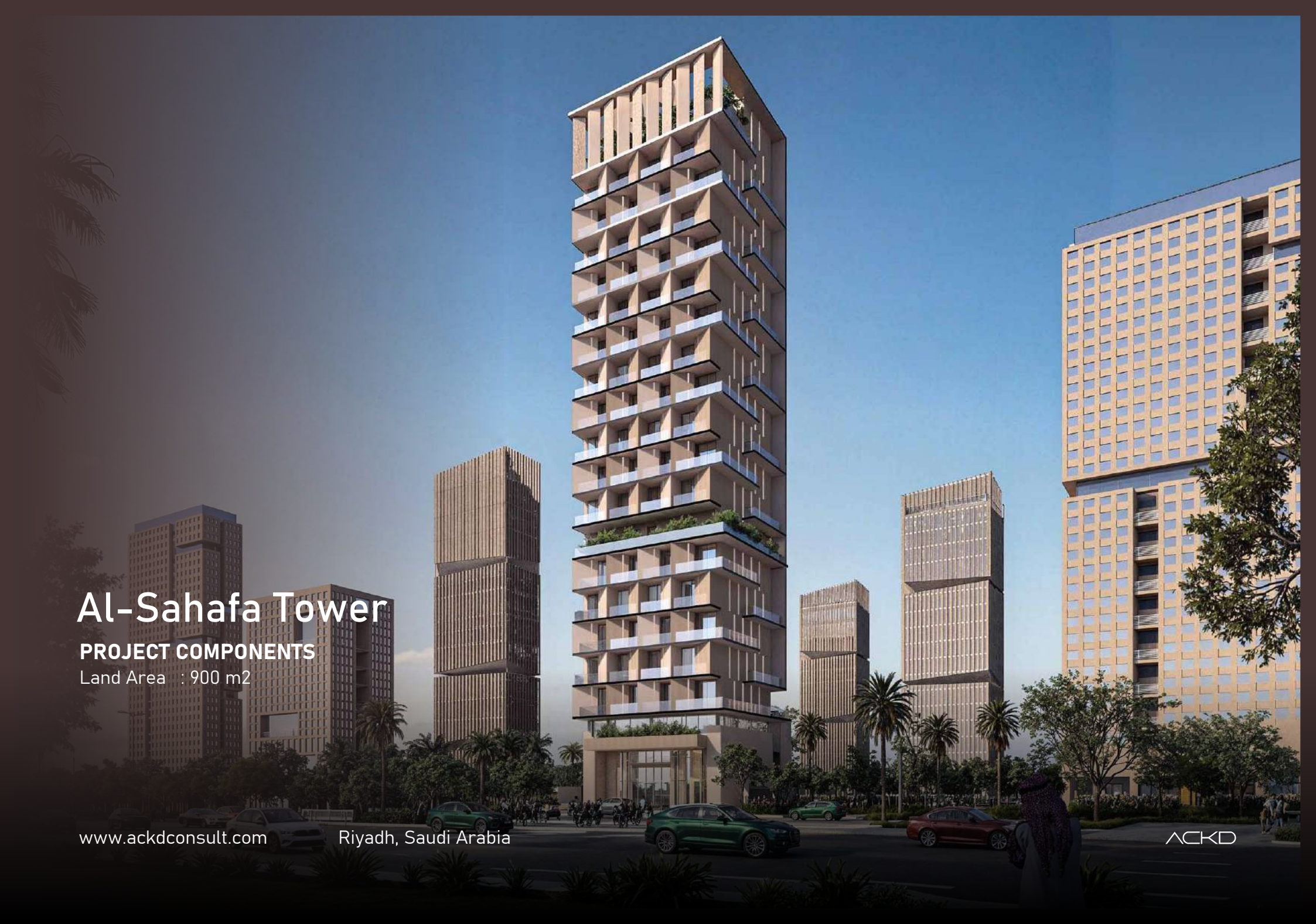



www.ackdconsult.com

Riyadh, Saudi Arabia

Al-Sahafa Tower

ACKD



Residential Tower | Luxury Apartments

PROJECT COMPONENTS

Land Area: 1,208 m²

www.ackdconsult.com

Riyadh, Saudi Arabia

ACKD



www.ackdconsult.com

Riyadh, Saudi Arabia



Residential Tower | Luxury Apartments

ACKD

Sajwa

PROJECT COMPONENTS

Land Area : 539,000 m²

www.ackdconsult.com

Riyadh, Saudi Arabia

ACKD







Aramak Real Estate Mixed- Use Development

PROJECT COMPONENTS

Land Area : 40,000 m²

Total GFA:

50177.50 m² Branded Hotel

18140.34 m² Residential Apartments

40,000 m² GFA (premium Office Spaces)

10,000 m² GFA Retail precinct

Area Of Expertise: Engineering Design, delivery,
AOR, Construction Supervision

www.ackdconsult.com

Riyadh, Saudi Arabia

ACKD

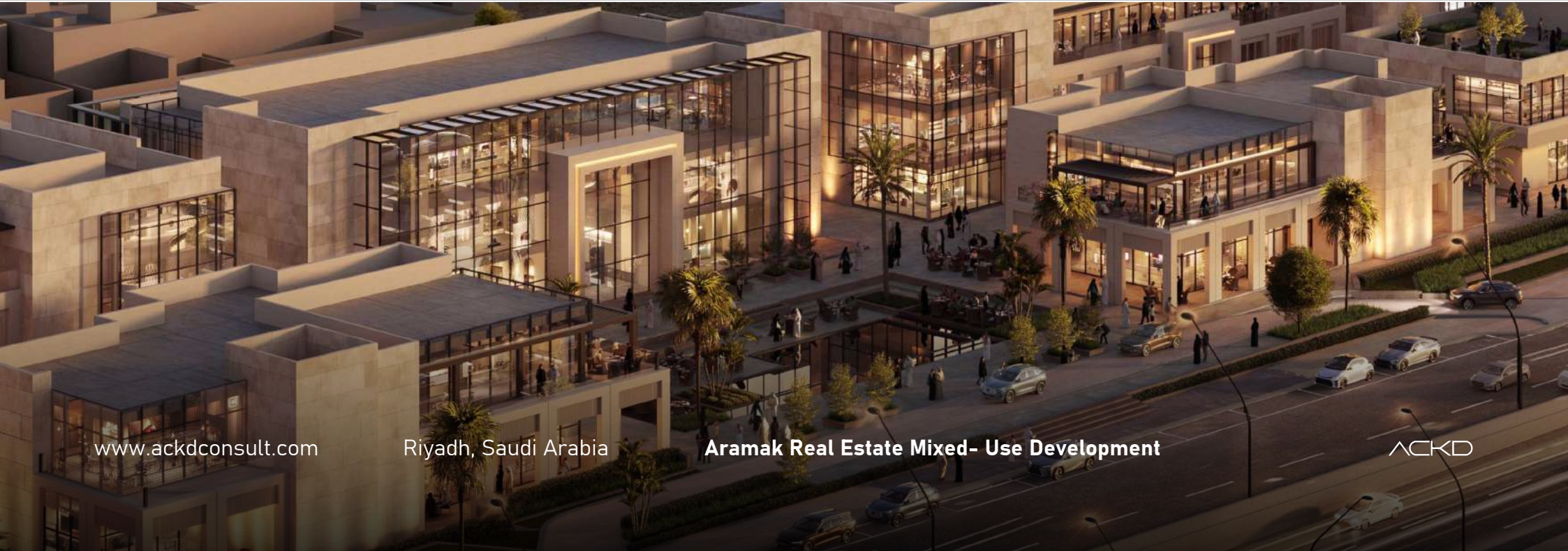

www.ackdconsult.com

Riyadh, Saudi Arabia

Aramak Real Estate Mixed- Use Development

ACKD



Crown Madarim 4-Stars Hotel

PROJECT COMPONENTS

Land Area: 11,822 m² 150 key room

Total GFA: 5,000 m²

Area Of Expertise:

Design Façade & Interior Design

www.ackdconsult.com

Riyadh, Saudi Arabia

ACKD



www.ackdconsult.com

Riyadh, Saudi Arabia

Crown Madarim

ACKD

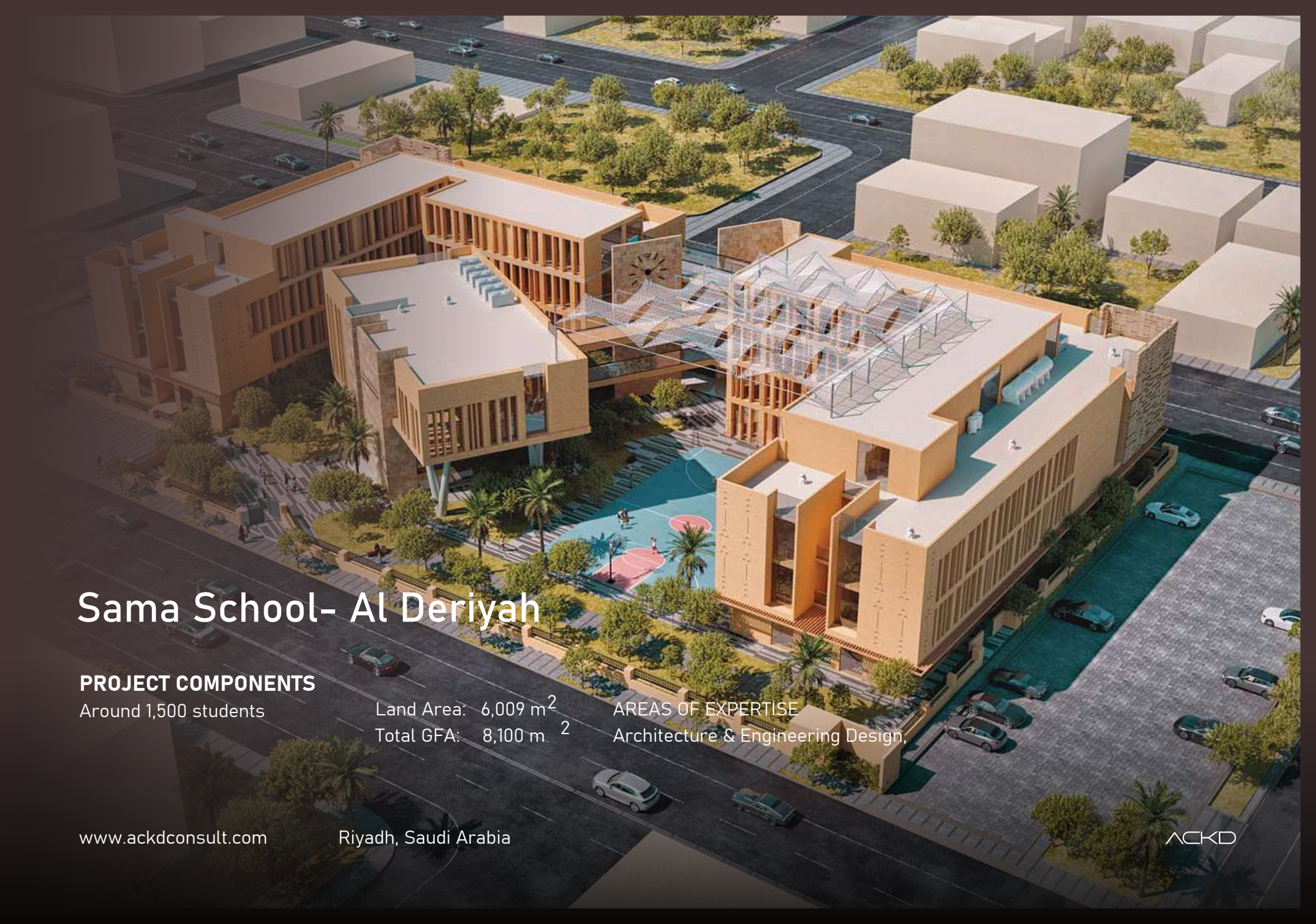

Sama School- Al Deriyah

PROJECT COMPONENTS

Around 1,500 students

Land Area: 6,009 m²
Total GFA: 8,100 m²

AREAS OF EXPERTISE

Architecture & Engineering Design,





Al Mozaini Real Estate Square Mall

PROJECT COMPONENTS

Urban Spaces

Public Gardens

Land Area: 28,362 m²
Total BUA: 12836 m²

AREAS OF EXPERTISE

Design Concept, Design Criteria



www.ackdconsult.com

Riyadh, Saudi Arabia

Al Mozaini Real Estate Sqaure Mall

ACKD

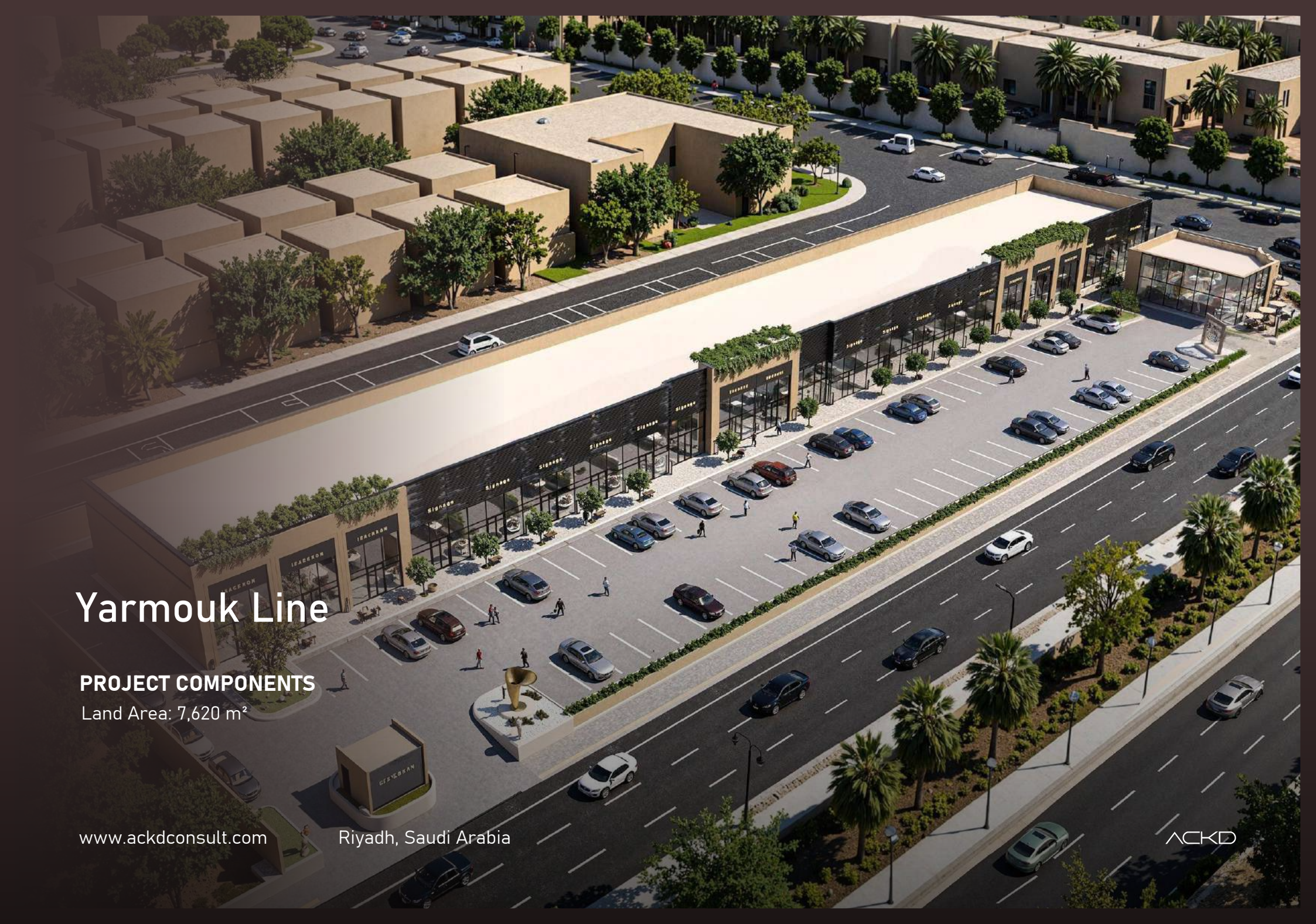
An architectural rendering of a modern commercial building complex. The main building is a long, single-story structure with a white facade and a dark, textured glass facade on the ground floor. The ground floor features large glass windows and doors, with the word "SIGNOR" repeated across the facade. The building is surrounded by a parking lot with several cars parked. In the foreground, there is a multi-lane road with a median strip containing palm trees and a small landscaped area with a golden sculpture. The background shows more buildings and a parking lot with several cars. The overall scene is set in a sunny, urban environment.

Yarmouk Line

PROJECT COMPONENTS

Land Area: 7,620 m²

www.ackdconsult.com

Riyadh, Saudi Arabia

ACKD

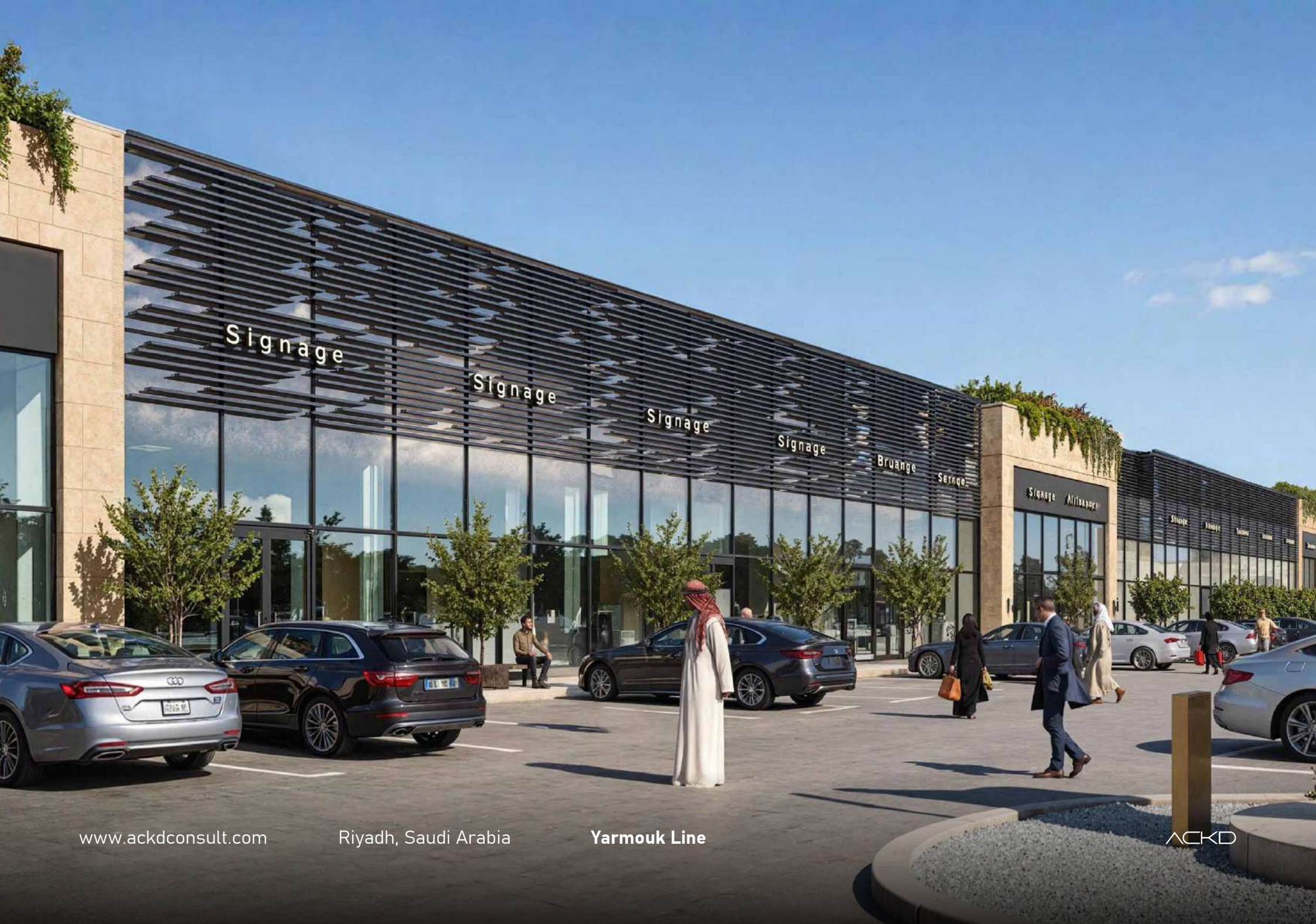



Al Mourouj School Complex

PROJECT COMPONENTS

4 floor levels, accommodates all educational levels

Land Area: 10,800 m²
BUA = 9,940.50 m²

Area Of Expertise:
Architecture & Engineering Design

www.ackdconsult.com

Riyadh, Saudi Arabia

ACKD





Downtown Center Mixed-Use Development

PROJECT COMPONENTS

Land Area: 7,500 m²
Total GFA: 15,532 m²

Area Of Expertise:
Concept Design, 3d Exterior Design and landscape Design, Permit

www.ackdconsult.com

Riyadh, Saudi Arabia

ACKD



جوين العقارية
JWIN REAL ESTATES

SIGNAGE

SIGNAGE

SIGNAGE

RESTAURANT

RESTAURANT

ENTRANCE



Dira Shopping Mall

PROJECT COMPONENTS

Shops

Restaurants

Land Area: 3,185 m²

Total BUA: 5,840 m²

AREAS OF EXPERTISE

Concept Design, Engineering Design, 3D Exterior Design and Landscape



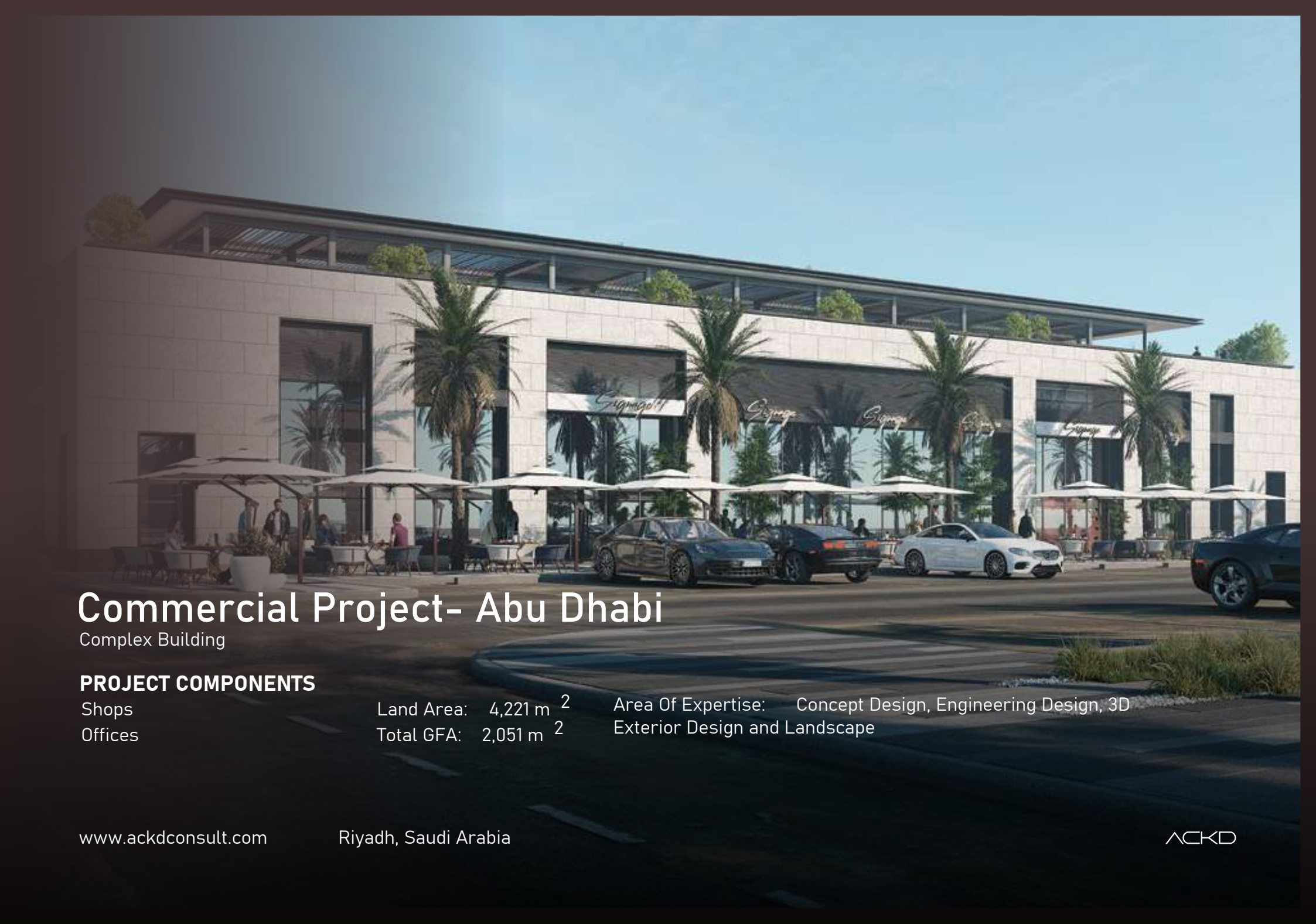

Commercial Project- Abu Dhabi

Complex Building

PROJECT COMPONENTS

Shops

Offices

Land Area: 4,221 m²

Total GFA: 2,051 m²

Area Of Expertise: Concept Design, Engineering Design, 3D

Exterior Design and Landscape



Signage



Sulaiman Al Habib

Nurses Dormitory Project

PROJECT COMPONENTS

5 floors, nurses' dormitory

Land Area: 3280 m²

Total BUA: 6,990 m²

Area Of Expertise:

Design Criteria, Engineering Design, Architectural Concept Design

www.ackdconsult.com

Riyadh, Saudi Arabia

ACKD



www.ackdconsult.com

Riyadh, Saudi Arabia

Sulaiman Al Habib

ACKD



PADEL STADIUMS

PROJECT COMPONENTS

Main general building
5 paddle courts

Land Area:	2,460 m ²	Area Of Expertise:
BUA:	286 m ²	2,174 m ²

www.ackdconsult.com

Riyadh, Saudi Arabia

ACKD





Najran International Airport Development

PROJECT COMPONENTS

Precast concrete airport façade development.

145m length, 25m structural height.

Complex engineering and installation challenges.

www.ackdconsult.com

Riyadh, Saudi Arabia

ACKD





Curve Offices Project Northern Ring Road

PROJECT COMPONENTS

Shops

Restaurants

Land Area: 8,400 m²

Total BUA: 8,133 m²

AREAS OF EXPERTISE

Preparing Engineering Drawings for all disciplines and obtain building permit



Madaen

PROJECT COMPONENTS

Land Area: 7,930.00 m²

Total GFA: 12,068.16 m²

www.ackdconsult.com

Riyadh, Saudi Arabia

ACKD







Residential Tower | Luxury Apartments

PROJECT COMPONENTS

Land Area: 2672 m²

Total BUA: 25702 m²

Area Of Expertise: Concept Design, Engineering Design, 3D Exterior Design and Landscape

www.ackdconsult.com

Riyadh, Saudi Arabia

ACKD



www.ackdconsult.com

Riyadh, Saudi Arabia

Residential Tower | Luxury Apartments

ACKD



Al Ammariyah Resort

PROJECT COMPONENTS

Land Area: 13,622 m²

www.ackdconsult.com

Riyadh, Saudi Arabia

ACKD

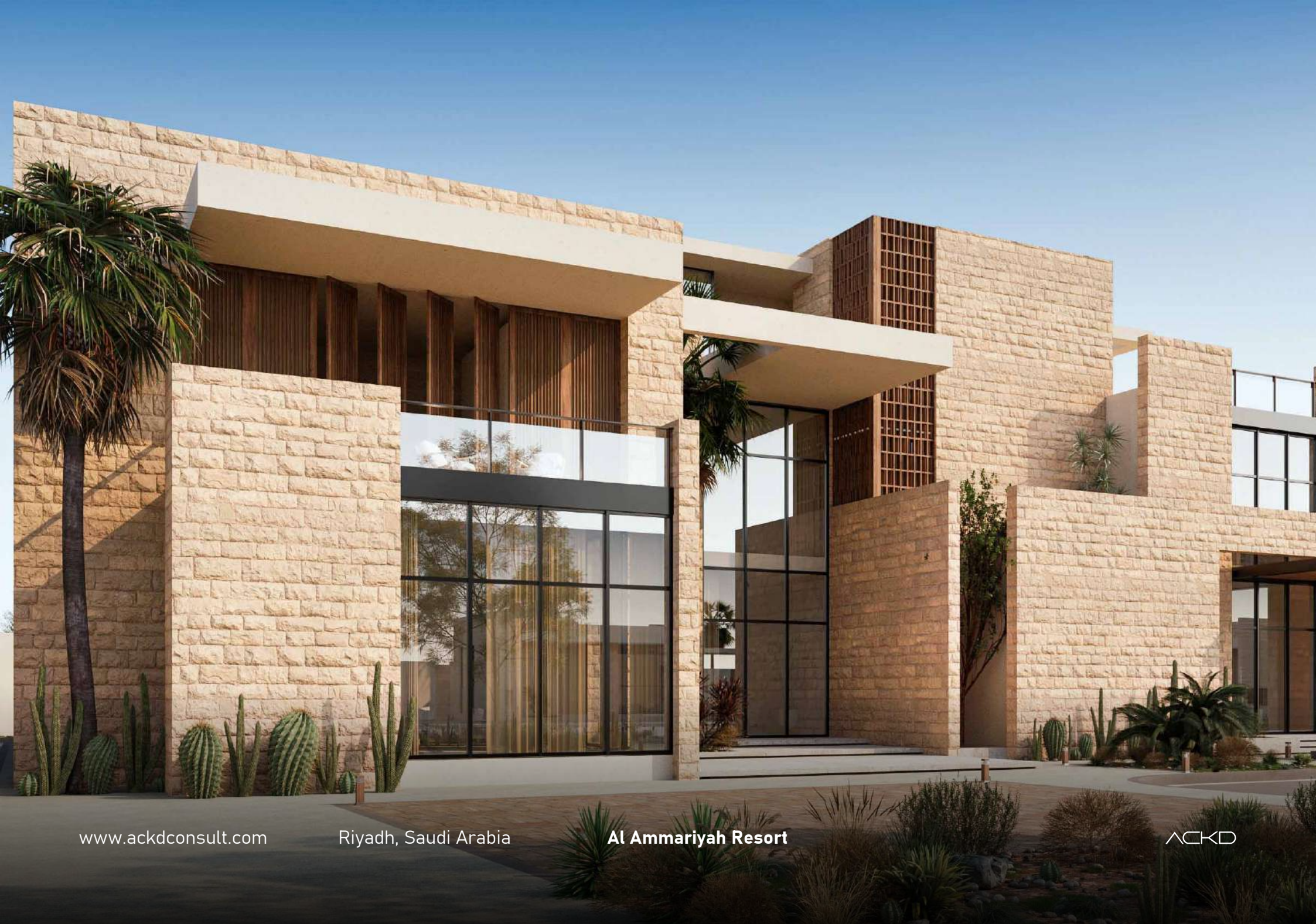

www.ackdconsult.com

Riyadh, Saudi Arabia

Al Ammariyah Resort

ACKD



Mulham Resort

PROJECT COMPONENTS

Land Area: 10,000 m²

www.ackdconsult.com

Riyadh, Saudi Arabia

ACKD





Dowayan Villas

PROJECT COMPONENTS

240 Villas – 6 Typologies

Land Area: 196,344 m²

Total GFA: 89,550 m²

Area Of Expertise: Engineering Design & Management

www.ackdconsult.com

Riyadh, Saudi Arabia

ACKD

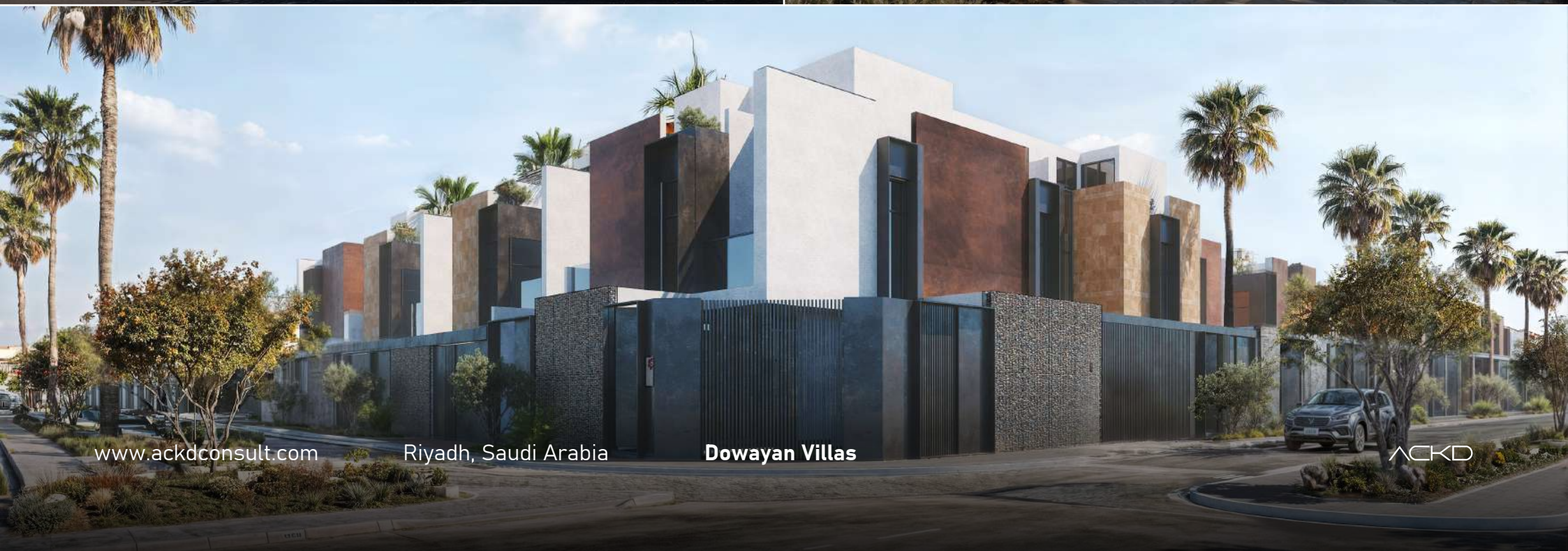

www.ackdconsult.com

Riyadh, Saudi Arabia

Dowayan Villas

ACKD

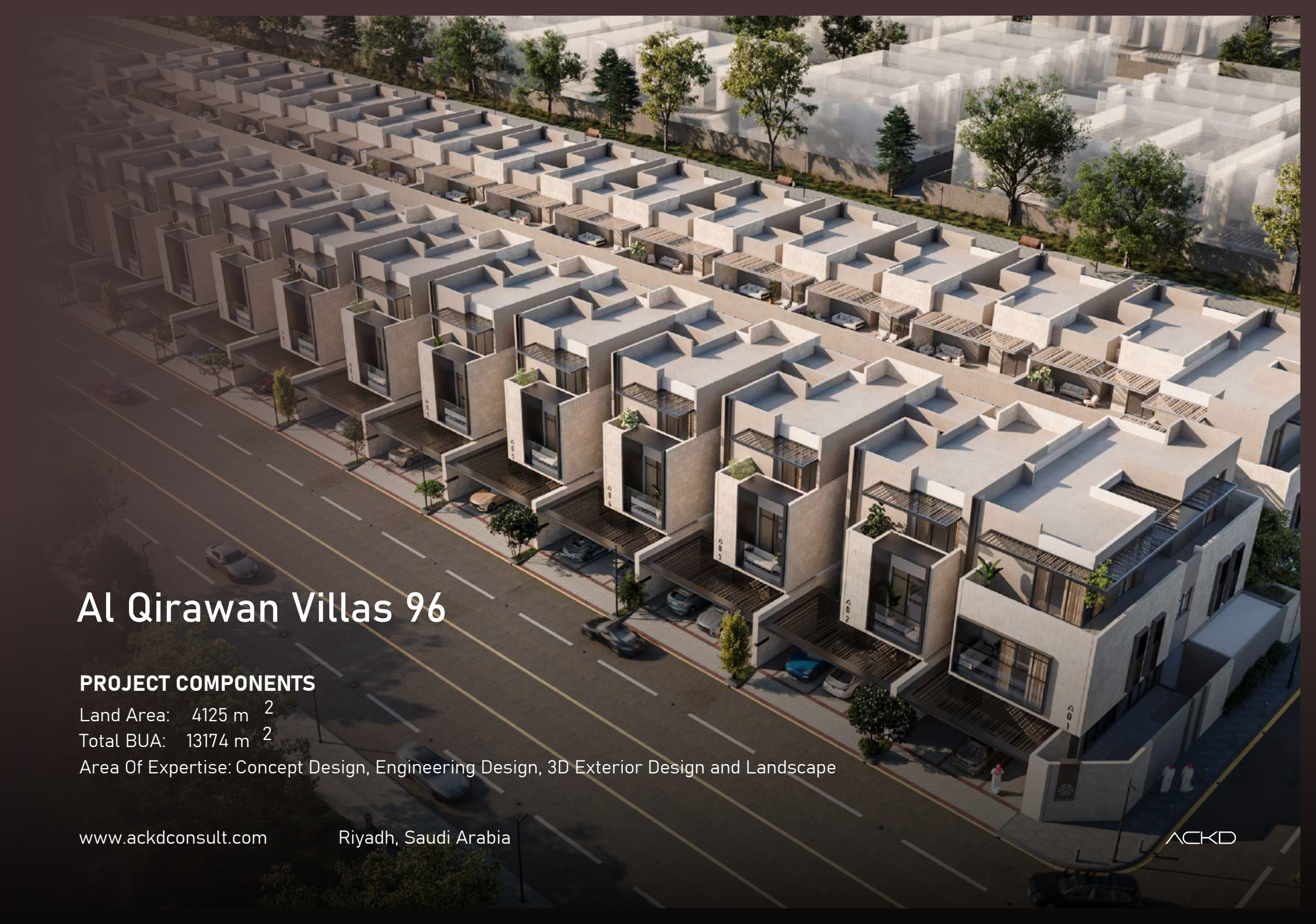

Al Qirawan Villas 96

PROJECT COMPONENTS

Land Area: 4125 m²

Total BUA: 13174 m²

Area Of Expertise: Concept Design, Engineering Design, 3D Exterior Design and Landscape

www.ackdconsult.com

Riyadh, Saudi Arabia

ACKD





Real Estate Development Project | Al-Qirawan

PROJECT COMPONENTS

Land Area: 3,200 m²

www.ackdconsult.com

Riyadh, Saudi Arabia

ACKD



B01

B01

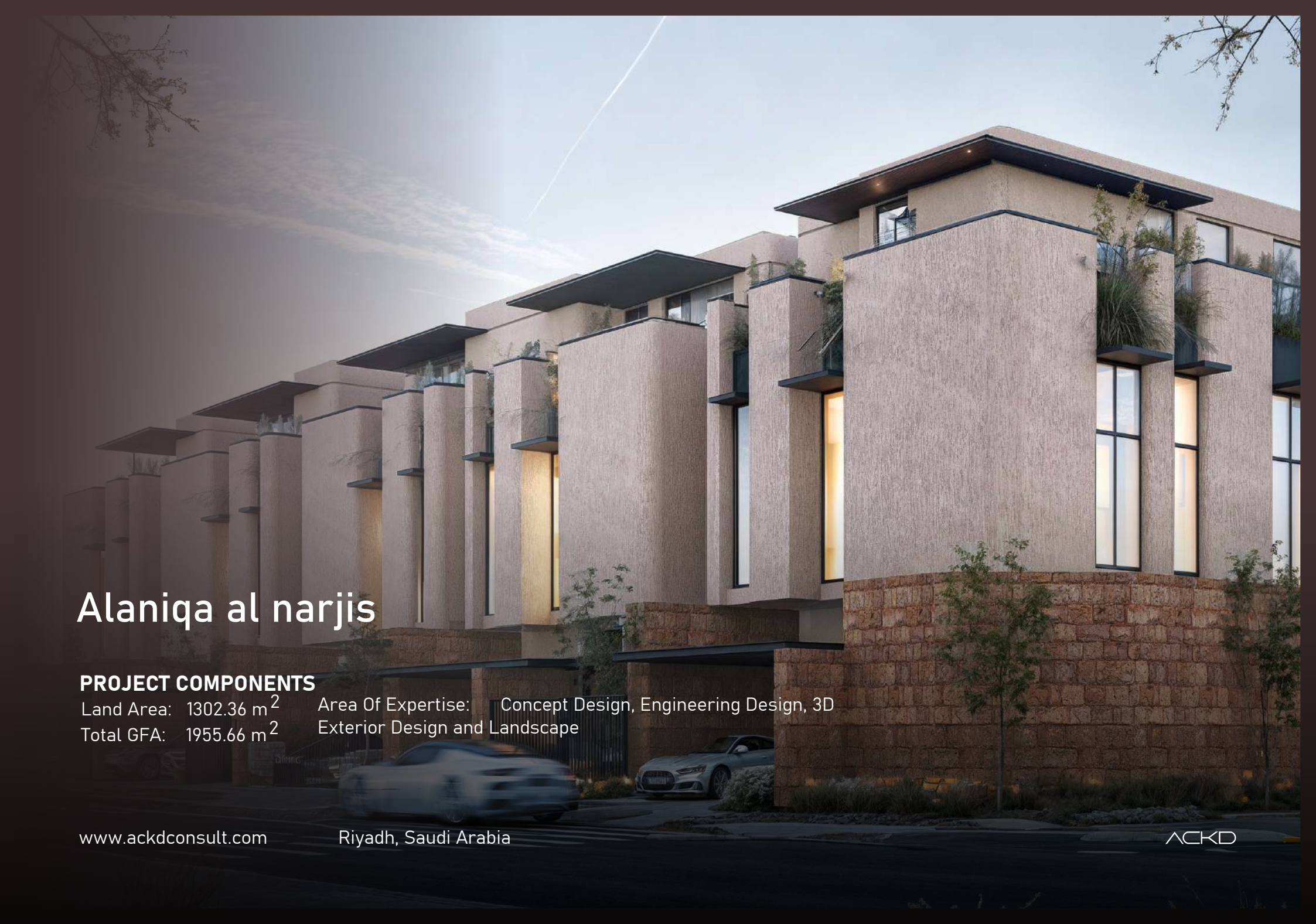

Alaniqa al narjis

PROJECT COMPONENTS

Land Area: 1302.36 m²

Total GFA: 1955.66 m²

Area Of Expertise: Concept Design, Engineering Design, 3D

Exterior Design and Landscape



www.ackdconsult.com

Riyadh, Saudi Arabia

Alaniqa al narjis

ACKD



Kana

PROJECT COMPONENTS

Land Area: 2100 m²

Area Of Expertise: Concept Design, Engineering Design, 3D
Exterior Design and Landscape

www.ackdconsult.com

Riyadh, Saudi Arabia

ACKD

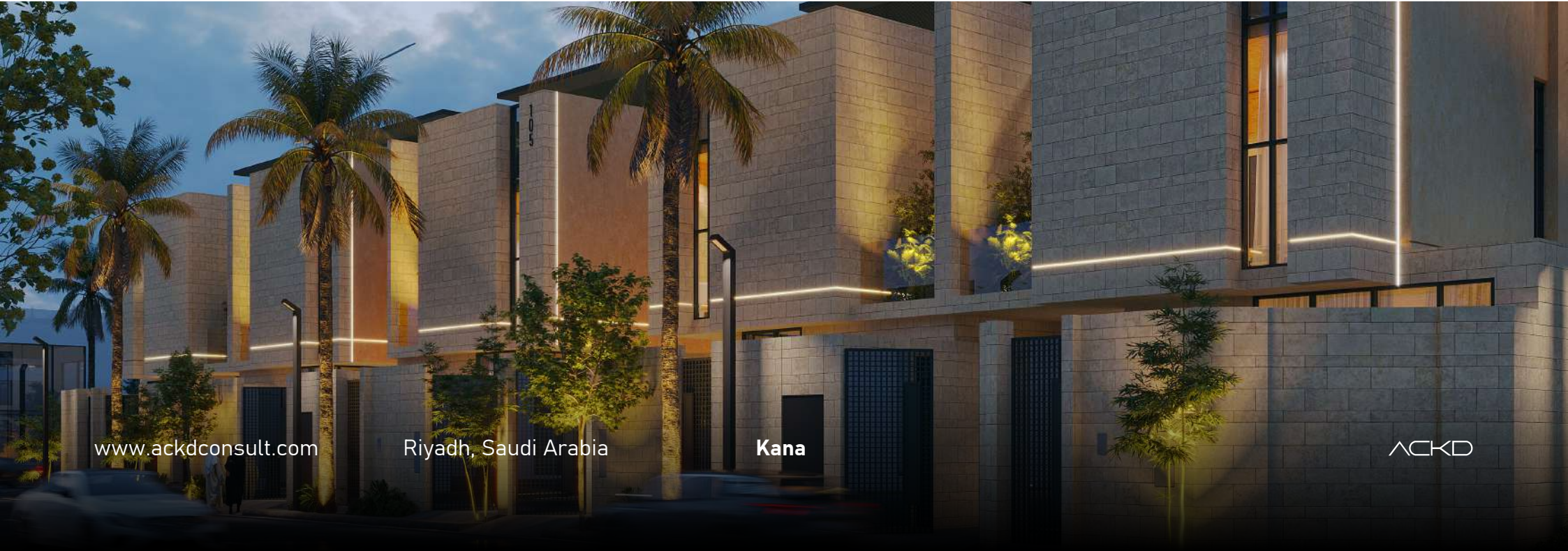

www.ackdconsult.com

Riyadh, Saudi Arabia

Kana

ACKD

Mithaaq

PROJECT COMPONENTS

Land Area: 730 m²

Total GFA: 1290 m²

Area Of Expertise: Concept Design, Engineering Design, 3D

Exterior Design and Landscape

www.ackdconsult.com

Riyadh, Saudi Arabia

ACKD



www.ackdconsult.com

Riyadh, Saudi Arabia

Mithaaq



ACKD

Nahdet Alnarjes

PROJECT COMPONENTS

Land Area: 1,500 m²

Total BUA: 2,070 m²

Area Of Expertise: Concept Design, Design Criteria, Engineering Design Drawings

www.ackdconsult.com

Riyadh, Saudi Arabia

ACKD



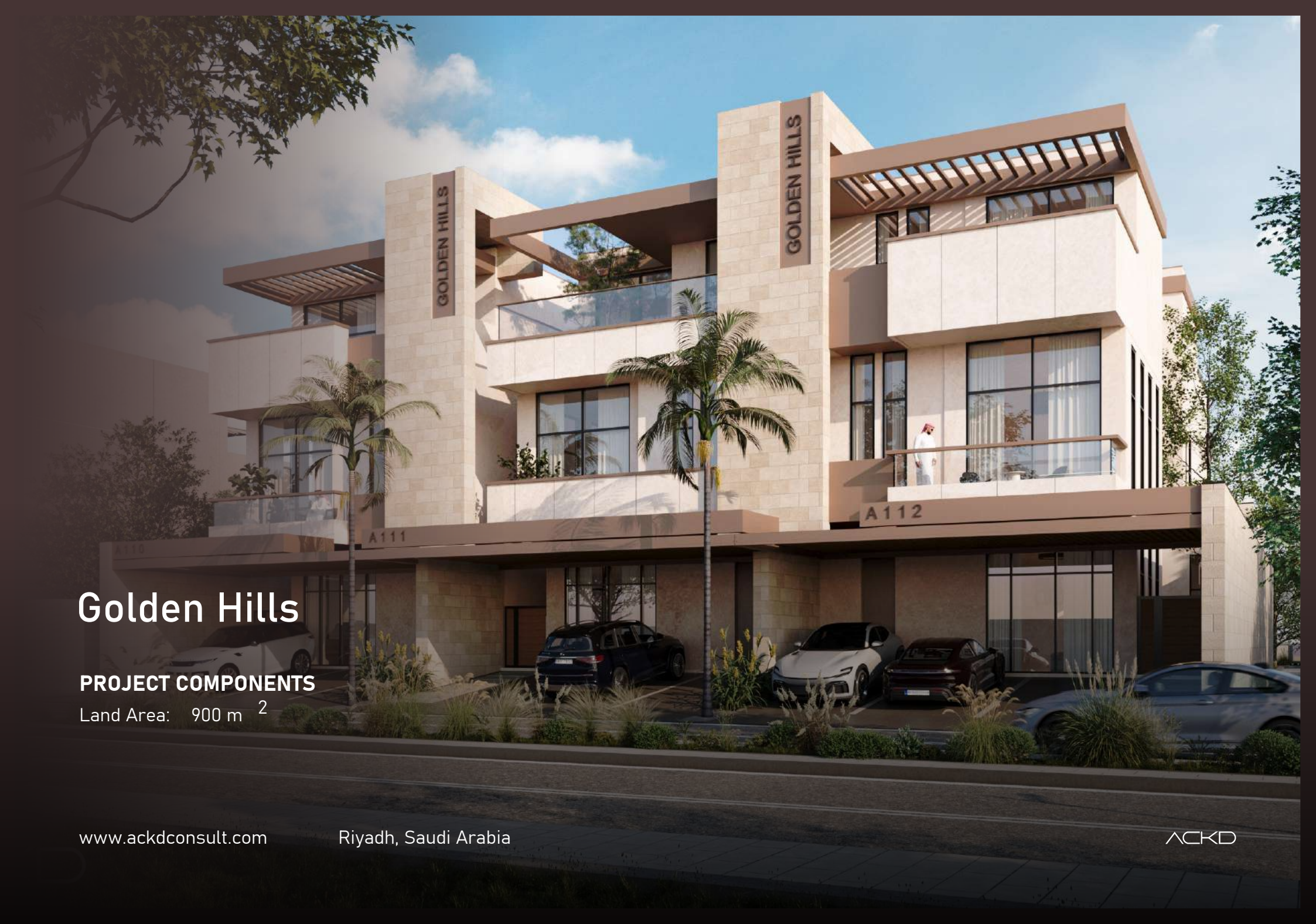

Golden Hills

PROJECT COMPONENTS

Land Area: 900 m²

www.ackdconsult.com

Riyadh, Saudi Arabia

ACKD



GOLDEN HILLS

GOLDEN HILLS

A 110

A 11

A 112

03

AOR Services

[BACK TO
TABLE OF CONTENT](#)

www.ackdconsult.com

Riyadh, Saudi Arabia

ACKD

ARCHITECT OF RECORD SERVICES

ACKD Consult provide the following services in Architect Of Record:

AOR services (Architect Of Record services) related to obtaining a license and approval for projects. The license and approval obtained from many accreditation bodies, like :

- Balady system services (KSA).
- Regulations of Saudi Ministry of Municipal and Rural Affairs and Housing (MOMRA).
- Diriyah Gate Development Authority (DGDA).
- General Authority for Civil Aviation (GACA).
- Ministry of Transport
- Regulations of (TBC) Tatweer Buildings Company (Saudi Ministry of Education).
- Royal committee of Riyadh city.
- Diriyah Gate Development Authority.
- Regulations of Saudi Ministry of Tourism (MT).
- Regulations of Saudi Ministry of Health (MOH).
- Architectural Requirements of Civil Defense.
- Regulations of Ministry of Islamic Affairs, Dawah and Guidance (MOIA).
- SEC, NWC, STC, CD, MOI, MOH.

04

Interior Design

[BACK TO
TABLE OF CONTENT](#)

Villa Interiors

LOCATION: NARJES, RIYADH





Anan View Tower Apartments

LOCATION: NARJES, RIYADH

www.ackdconsult.com

Riyadh, Saudi Arabia

ACKD

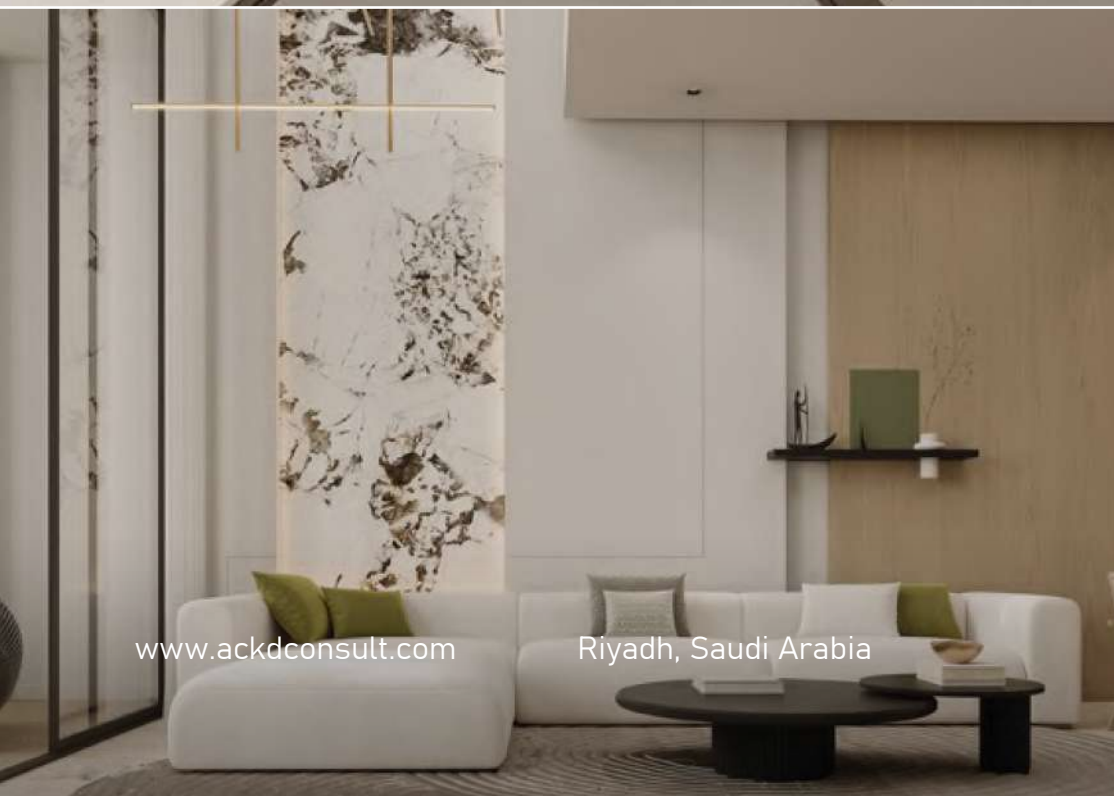

Wedding Hall

Location: Al Nahda, Riyadh, Ksa

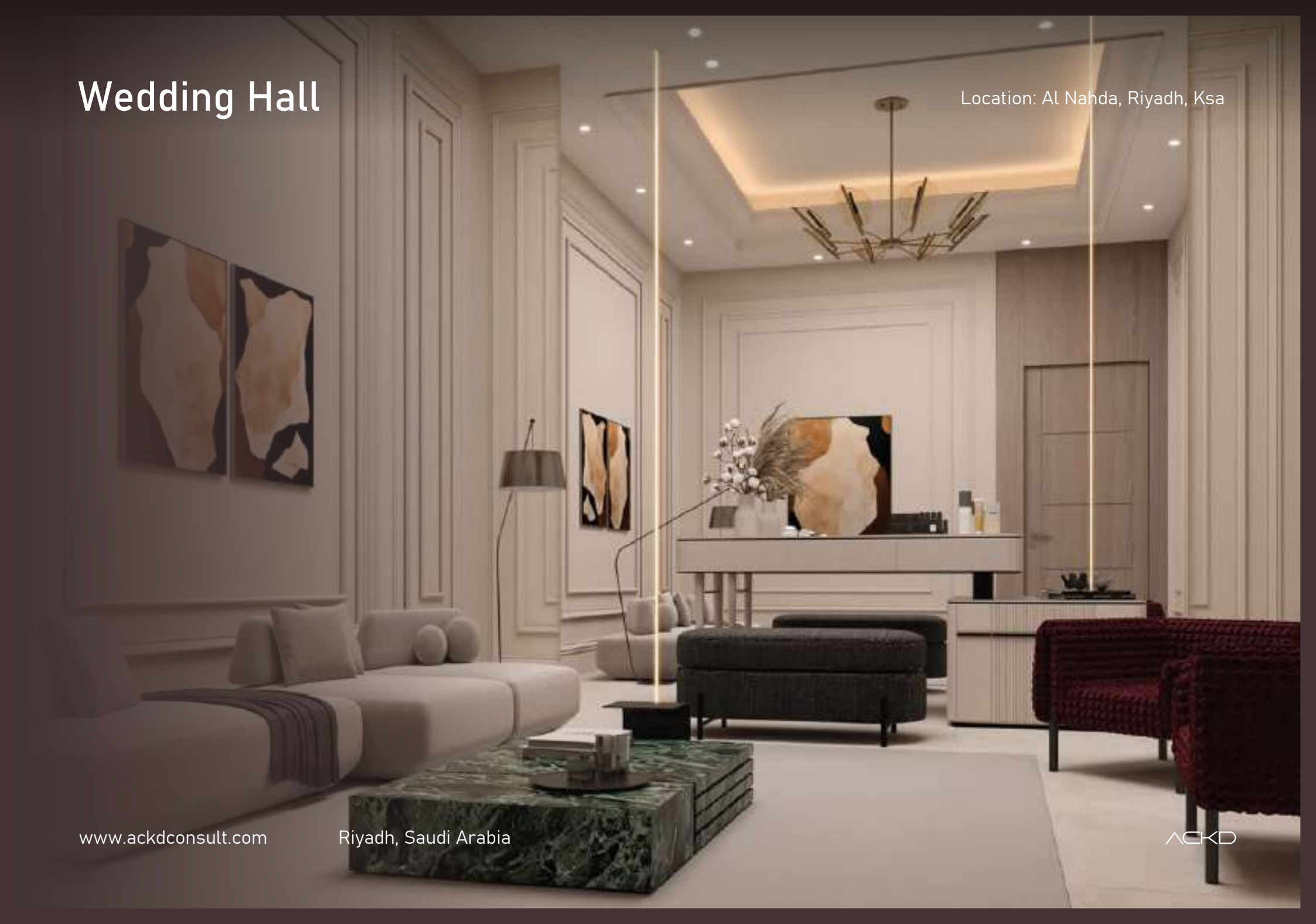





Villa Interiors

LOCATION: RIYADH

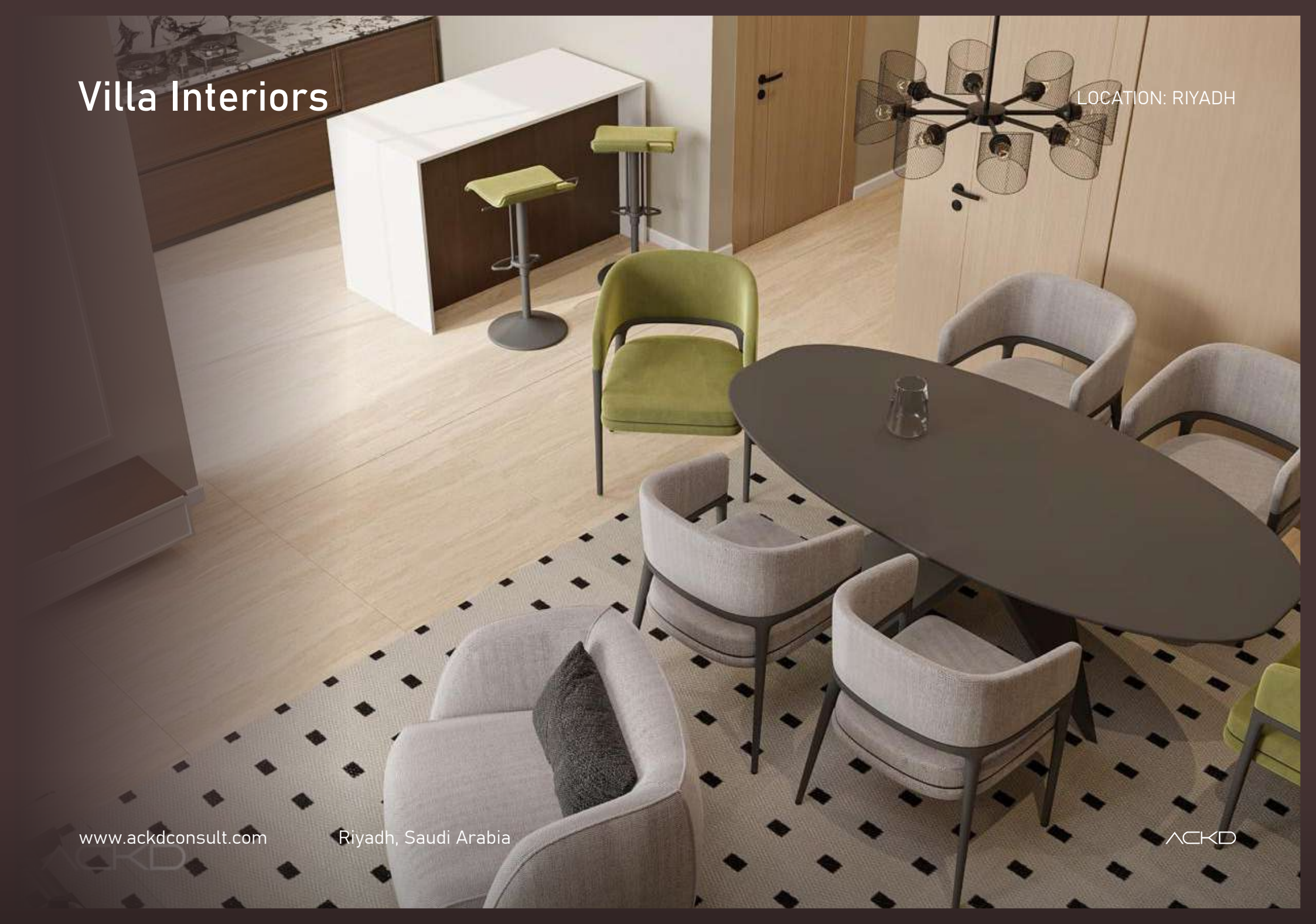





Villa Interiors

LOCATION: RIYADH





Villa Interiors

LOCATION: RIYADH

www.ackdconsult.com

Riyadh, Saudi Arabia

ACKD

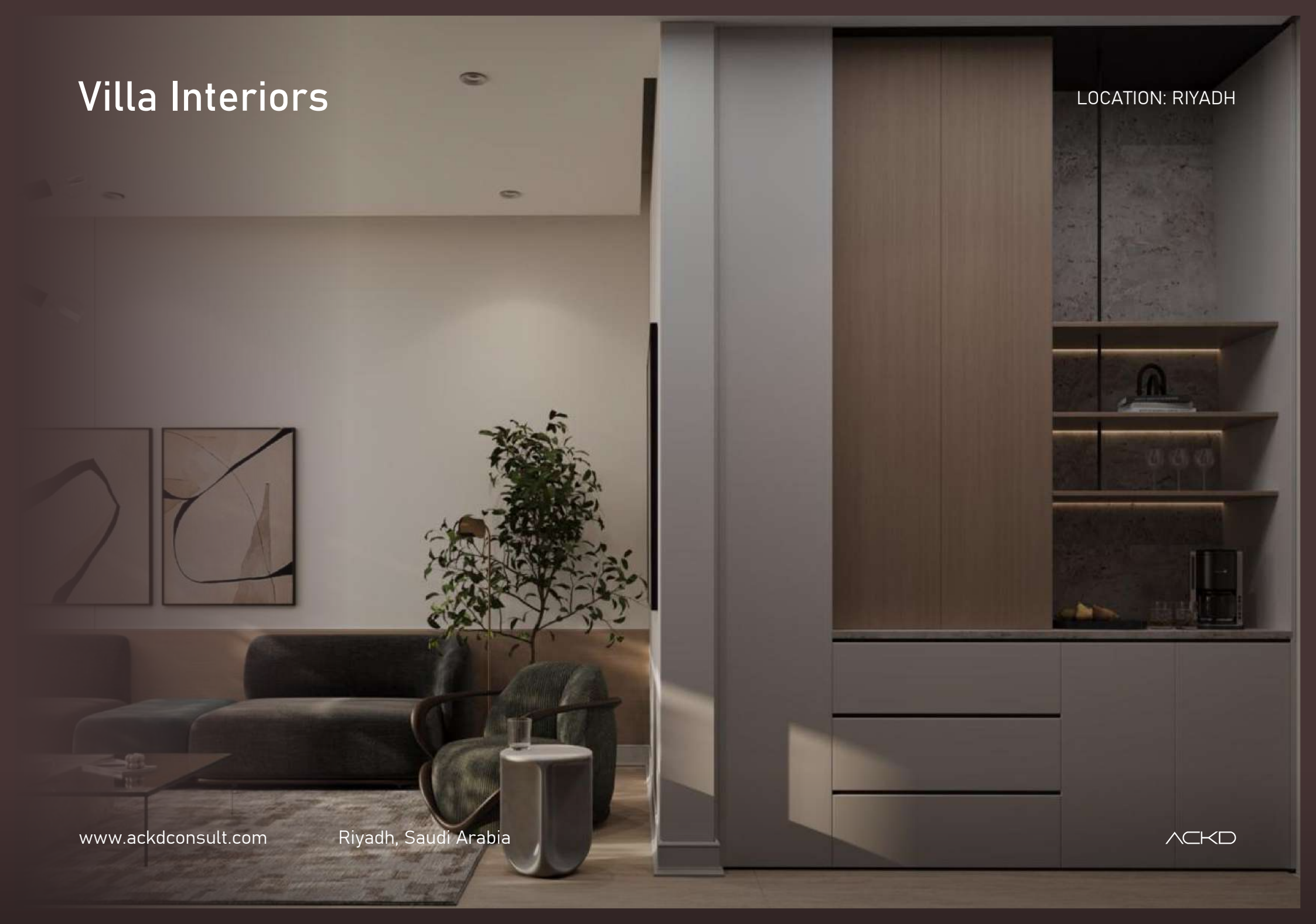



05

BACK TO
TABLE OF CONTENT

Supervision & Project Management

www.ackdconsult.com

Riyadh, Saudi Arabia

ACKD



GALLERY OF PROJECTS

Our experience includes many types of occupancies and buildings:

1

Entertainment

2

Industrial

3

Commercial

4

Residential

5

Educational

6

Health care

7

High-Rise

WE ARE SPECIALIZED AT

1

Review of drawings and specifications.

2

Supervision inspection.

3

Approval of materials

4

Review and approval of contractors' invoices.

5

Make weekly and monthly reports for client .

6

Submit the required reports for AMANA & WAFI.

KING FAHAD TOWER

Olaya Street Riyadh

Design Review.

Construction Supervision.

Project Documentation and Reporting:

Achieving the targeted level of quality for the project.

Controlling the project budget.

Completing the project within the specified timeframe.

Client: Almashari Aloula

www.ackdconsult.com

Riyadh, Saudi Arabia

ACKD

Nawa Tower

Riyadh

Design Review.

Construction Supervision.

Project Documentation and Reporting:

Achieving the targeted level of quality for the project.

Controlling the project budget.

Completing the project within the specified timeframe.

Client: Nawa Real Estate

www.ackdconsult.com

Riyadh, Saudi Arabia

ACKD



Al-Thiyab Tower

Riyadh

Design Review.
Project Management Consultant.

Client: Abdulaziz Althiyab Company

www.ackdconsult.com

Riyadh, Saudi Arabia

ACKD

Kalima Tower

Riyadh

Design Review.
Project Management Consultant.

www.ackdconsult.com

Riyadh, Saudi Arabia

Client: Kalima Real Estate Development

ACKD





Palms Tower

Riyadh

Supervision
reporting wafi

www.ackdconsult.com

Riyadh, Saudi Arabia

ACKD





Dorar Al-layali

Commercial Building consists of 8 floors – Riyadh

Design Review.

Construction Supervision.

Project Documentation and Reporting:

Achieving the targeted level of quality for the project.

Controlling the project budget.

Completing the project within the specified timeframe.

www.ackdconsult.com

Riyadh, Saudi Arabia

ACKD



Al-Yasmin Villas

20 Villa

Client: Almashari Aloula
Location: Alyasmin Destrict

Status: Finished
SOW: Supervision

www.ackdconsult.com

Riyadh, Saudi Arabia

ACKD



Hayaz Project

Residential Villas located in Riyadh-KSA Total Built up area = 13,500 m² 16 residential villas and 9 residential buildings.

Design .
Project Management Consultant.

www.ackdconsult.com

Riyadh, Saudi Arabia

ACKD

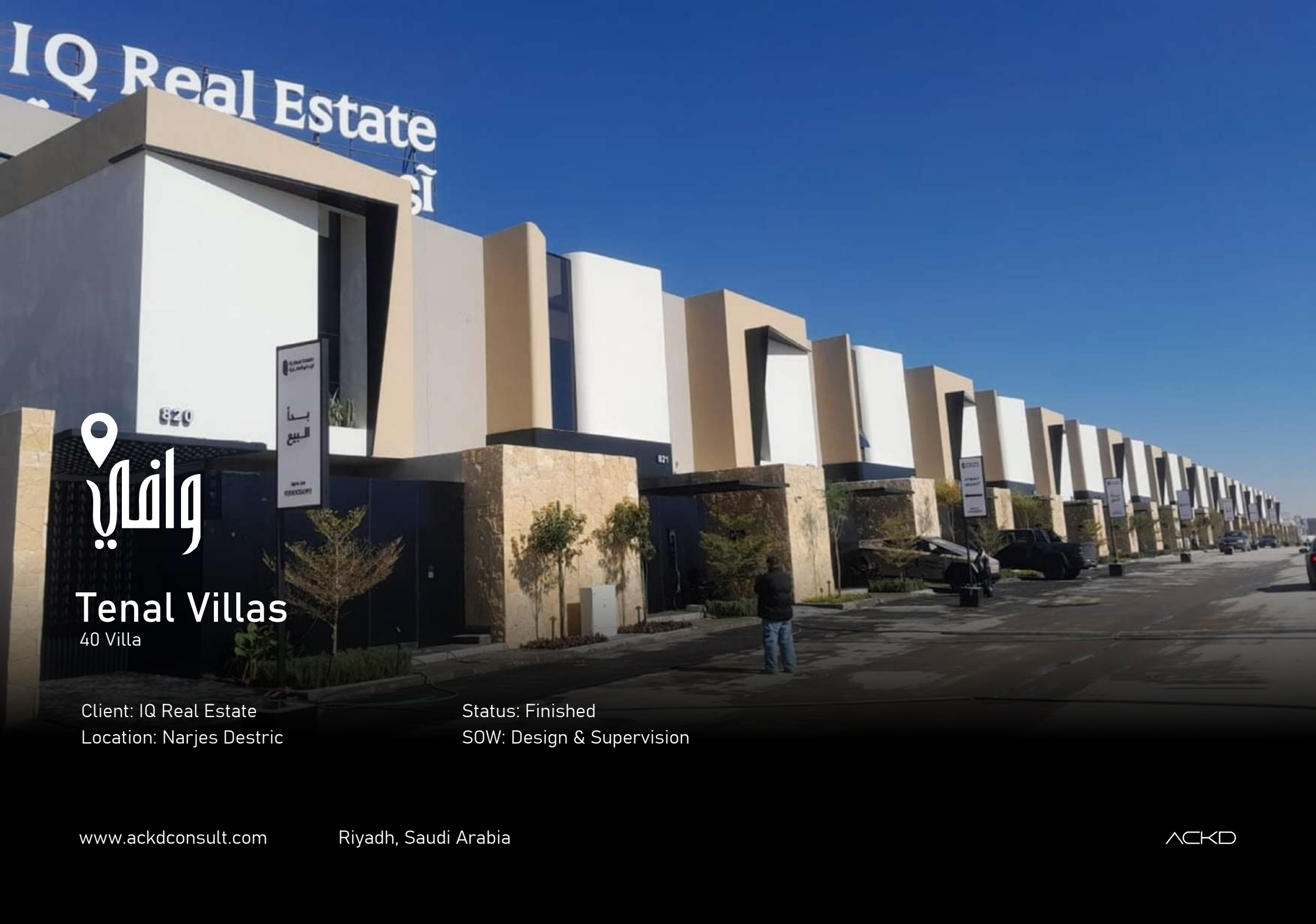

IQ Real Estate



Tenal Villas

40 Villa

Client: IQ Real Estate
Location: Narjes Destruc

Status: Finished
SOW: Design & Supervision



Al-Mohamadiah (2,3) Villas

80 Villa

Client: Almashari Aloula
Location: Almohamdiah Destrict

Status: Finished
SOW: Supervision



Al-Ghadeer Villas

Riyadh

Design Review.
Project Management Consultant.

Client: Irad Al Muttahida

www.ackdconsult.com

Riyadh, Saudi Arabia

ACKD

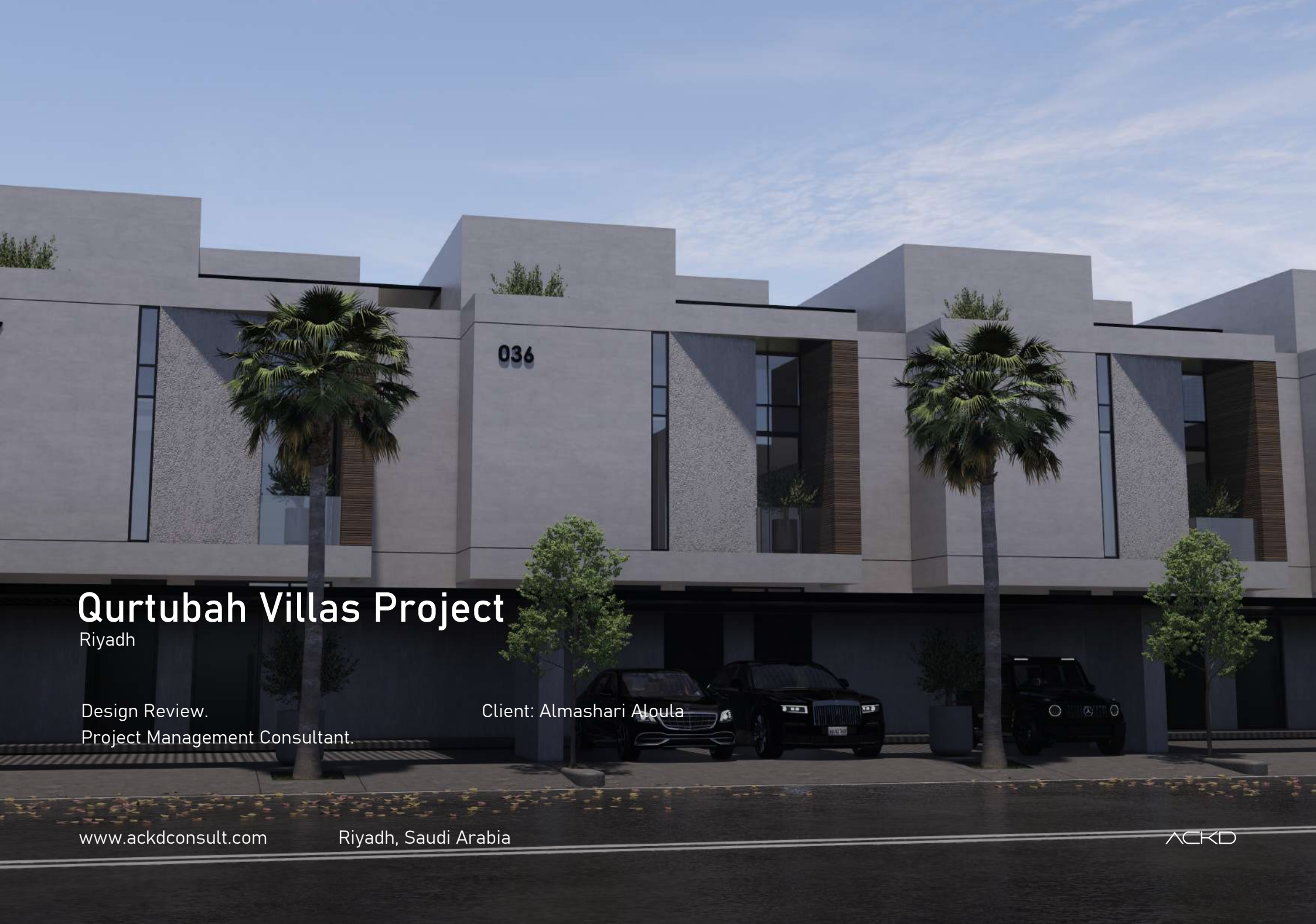

Qurtubah Villas Project

Riyadh

Design Review.
Project Management Consultant.

Client: Almashari Aloula

www.ackdconsult.com

Riyadh, Saudi Arabia

ACKD



Project B1578 | Commercial Office Building

Riyadh

Design Review.
Project Management Consultant.

Client: Raven Real Estate

www.ackdconsult.com

Riyadh, Saudi Arabia

ACKD

A detailed architectural rendering of a modern multi-story building, Al-Ma'alem Park. The building features a prominent facade with large glass windows and a complex, geometric pattern of dark, angular panels that create a textured, crystalline appearance. The ground floor is a commercial level with large glass storefronts and signage that reads "Signage". The building is set in an urban environment with palm trees, other greenery, and a few people walking on the sidewalk. The sky is clear and blue.

Al-Ma'alem Park

Project Area: 28,000 sqm

Number of Floors: Basement + 4 Floors

Client: Ajbil Real Estate Development

Design Review.

Construction Supervision.

Project Documentation and Reporting:

Achieving the targeted level of quality for the project.

Controlling the project budget.

Completing the project within the specified timeframe.



Al-Zuhour Park

Project Area: 20,000 sqm

Number of Floors: Basement + 3 Floors

Client: Ajbal Real Estate Development

Design Review.

Construction Supervision.

Project Documentation and Reporting:

Achieving the targeted level of quality for the project.

Controlling the project budget.

Completing the project within the specified timeframe.

06

Fire & Life Safety Portfolio

[BACK TO
TABLE OF CONTENT](#)

FIRE SAFETY SERVICES

C. Fire and Life Safety Consulting

Design of Fire Protection Systems
Firefighting systems
Fire Detection & Alarm Systems
Ventilation and Smoke systems
Emergency light and Emergency power.
Evacuation routes and plans.
Life Safety Plans.

Hand over Projects to CD.
Hand over All project to AHJ with a
release operation license

Supervision
Supervision the installation of
fire safety systems.

Design Review
Design Review of all fire
safety systems.

Fire Engineering Studies
Fire & Smoke Modelling
Evacuation Modelling.

Approval From CD, HCIS, MODON
Approval of all FLS drawings and
reports from Civil Defense and
other AHJ

Inspection, Testing, and handover
Inspect the fire safety system
according to the applicable
codes.
Testing of all fire safety systems.

Approval Certificate Form Civil Defense

تسجيل الدخول تسجيل الآن En سلامة Salamah

عودة للرئيسية < المكاتب الهندسية والفنية المعتمدة

منطقة الرياض المنطقة مكتب استشاري نوع المكتب

أكد اسم المكتب الفني / الاستشاري الرياض المدينة

928459 رمز التحقق *

عودة مسح بحث

الرقم	اسم المكتب الفني / الاستشاري	اسم الفرع	نوع المكتب	العنوان	المدينة	المنطقة	معلومات الاتصال	الفرع
1	شركة أكد للاستشارات الهندسية شركة شخص واحد	شركة أكد للاستشارات الهندسية شركة شخص واحد	مكتب استشاري	طريق الأمير محمد بن سلمان بن عبدالعزيز الربيع	الرياض	منطقة الرياض	عبدالله صالح بن عبدالله آل بشر 966504560090 gmgr@ackdco.com	

Previous Projects

NEOM BAY AIRPORT PH 1& 2 - 3C STAGE

ACKD scope of work:

- > 3rd Party Peer Review
- > Approval of all fire safety Systems.
- > Testing & Commissioning



Previous Projects

NEOM Mobility Hub - 3C STAGE

ACKD scope of work:

- > Design review of fire safety systems.
- > Propose solutions on the design to comply with SBC requirements.
- > Preparing of Fire strategy report
- > Approval of all fire safety Systems.



نيوم NEOM

BEC

شركة بكين الإمارات
Beijing Emirates Company



Previous Projects

NEOM Water Reservoir project - HCIS & LPFS

ACKD scope of work:

- > Design review of fire safety systems.
- > Propose solutions on the design to comply with HCIS requirements.
- > Approval of all fire safety Systems from HCIS -LPFS.



نيوم NEOM



Previous Projects

SINDALAH ISLAND - CLUSTERS (3,4,6) - 3C STAGE

ACKD scope of work:

- > Design review of fire safety systems.
- > Design Life Safety drawings.
- > Preparing of Fire strategy report
- > Approval of all fire safety Systems.



نيوم NEOM

BEC

شركة بكين الإمارات
Beijing Emirates Company



Previous Projects

AMAALA STAFF VILLAGE - ZONE 06a & 06b

ACKD scope of work:

- > Design review of fire safety systems.
- > Propose solutions on the design to comply with HCIS requirements.
- > Approval of all fire safety Systems from HCIS - LPFS.



Previous Projects

AMAALA Staff Housing Zone 4

ACKD scope of work:

- > Design review of fire safety systems.
- > Propose solutions on the design to comply with HCIS requirements.
- > Approval of all fire safety Systems from HCIS - LPFS.



Joint Venture



Previous Projects

SALINE Electrical Generator Building - Tofieh well, Jubail

ACKD scope of work:

- > Design review of fire safety systems.
- > Propose solutions on the design to comply with HCIS requirements.
- > Approval of all fire safety Systems from HCIS .



Previous Projects

SALINE Electrical Generator Building - Tofieh well, Jubail

ACKD scope of work:

- > Review and Approval of fire safety Systems.
- > Testing & Inspection of fire safety systems.
- > Handover to Civil Defense.

ACKD works include many restaurants in Bujiri project:

- > VILLA MAMAS
- > ANGELINA
- > HAKKASAN
- > Food Hall
- > LONG CHIM
- > SARABETH
- > CHEZ BRUNO



Previous Projects

Ministry of Culture Headquarters - DIRIYAH

ACKD scope of work:

- > Review/Redesign and Approval of fire safety Systems.
- > Testing & Inspection of fire safety systems.
- > Handover to Civil Defense.



Previous Projects

ASSIR WATER TRANSMISSION SYSTEM

Scope:
Prepare Front End Engineering
design for SAIS approval.



Previous Projects

Prince Sultan Bin Abdul Aziz City for Humanitarian Services

ACKD Consult Sow: Full Engineering design for the Extension part (614 beds) + FLS design review of existing buildings, inspection, and handover for the whole city.



Previous Projects

Hilton Riyadh

ACKD scope of work:

- > Assessment of fire safety systems according to SBC and Hilton requirements..
- > Redesign of Fire Safety drawings where required.
- > Preparing FLS BOQ.



Previous Projects

Riyadh Metro Project (Line 5&6 with FAST Consortium).



ACKD scope of work:

- > Fire & Life Safety design review.
- > Testing & Inspection of Fire Safety systems.
- > Handover to Civil Defense.



الهيئة الملكية لمدينة الرياض
ROYAL COMMISSION FOR RIYADH CITY



Previous Projects

Riyadh Metro Project (Line 3 with ANM)



ACKD scope of work:

- > Fire & Life Safety design review.
- > Testing & Inspection of Fire Safety systems.
- > Handover to Civil Defense.



الهيئة الملكية لمدينة الرياض
ROYAL COMMISSION FOR RIYADH CITY



Previous Projects

Several Towers at King Abdulla Financial District (KAFD)

- > KAFD - Tower Building Parcel 1.09
- > ACKD Consult Sow: Fire & Life Safety design review, inspection, and handover to Civil Defense.



Previous Projects

Several Towers at King Abdulla Financial District (KAFD)

- > KAFD - Tower Building Parcel 1.10
- > ACKD Consult Sow: Fire & Life Safety design review, inspection, and handover to Civil Defense



Previous Projects

Several Towers at King Abdulla Financial District (KAFD)

- > KAFD - Tower Building Parcel 1.11
- > ACKD Consult Sow: Fire & Life Safety design review, inspection, and handover to Civil Defense.



Previous Projects

Several Towers at King Abdulla Financial District (KAFD)

- > KAFD - Tower Building Parcel 1.14
- > ACKD Consult Sow: Fire & Life Safety design review, inspection, and handover to Civil Defense.

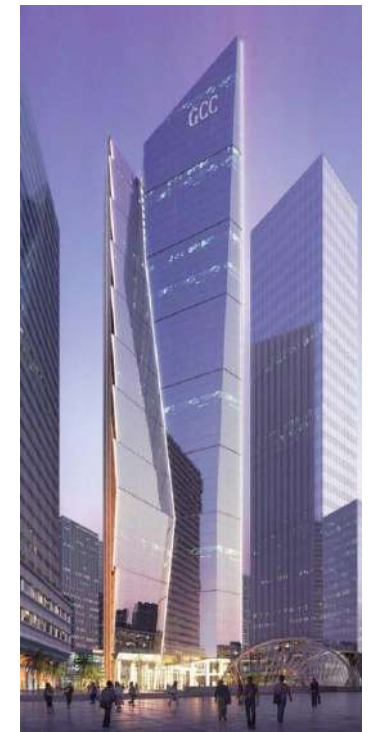

Previous Projects

Several Towers at King Abdulla Financial District (KAFD)

- > KAFD - Tower Building Parcel 1.15 (World Trade Centre)
- > ACKD Consult Sow: Fire & Life Safety design review, inspection, and handover to Civil Defense.



Previous Projects

Several Towers at King Abdulla Financial District (KAFD)

- > KAFD - Tower Building Parcel 4.10
- > ACKD Consult Sow: Fire & Life Safety design review, inspection, and handover to Civil Defense.



Previous Projects

RAFAL TOWER

- > ACKD Consult Sow: Fire & Life Safety design review, inspection, and handover to Civil Defense



Previous Projects

KINGDOM TOWER

- > ACKD Consult Sow: Fire & Life Safety design review, inspection, and handover to Civil Defense



Previous Projects

Al Faisaliah Trading Center

ACKD Consult Sow: Fire & Life Safety design review, inspection, and handover to Civil Defense





07

Urban Planning

[BACK TO
TABLE OF CONTENT](#)

Previous Projects

Integrated Logistics Bonded Zone (ILBZ) Project King Khalid International Airport



ACKD scope of work:

liaise with government and authority agencies and obtain the information regarding their current infrastructure services that surround the site or within the site plot boundaries

Review and approval of architectural drawings regarding life safety & local authority codes.

Design review of fire safety systems.

Approval of all fire safety Systems from GACA and CD.



Previous Projects

TRAFFIC IMPACT STUDY

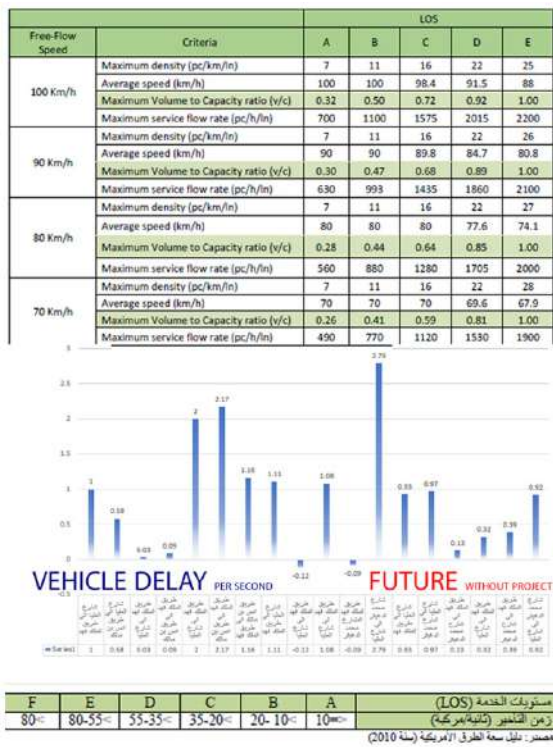

Project W, Al Ula

Worker Village

Components:

- > Junior Accommodation
- > Worker Accommodation
- > Mosque
- > Laundry
- > Clinic
- > Mini Market
- > Operation and Facility Management Office
- > Public Toilet

Land Area: 73343 m²

Total BUA: 12300 m²

Area Of Expertise:

Utilities, Development of the Concept Design

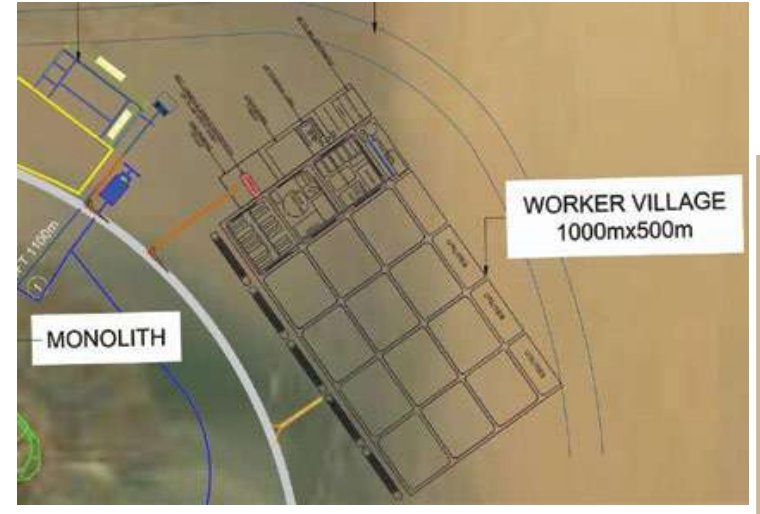

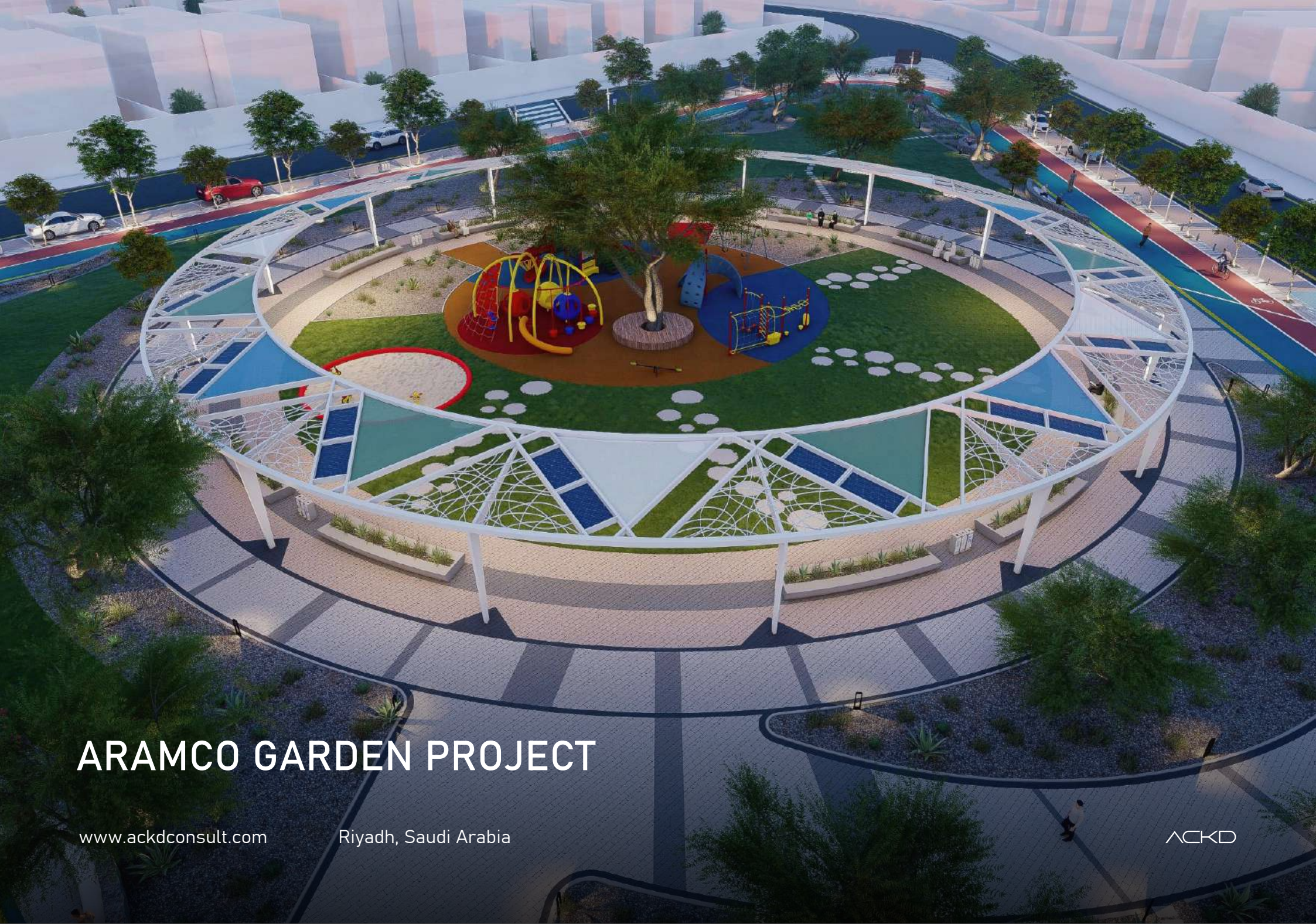

ARAMCO GARDEN PROJECT

www.ackdconsult.com

Riyadh, Saudi Arabia

ACKD

GROVE MALL ALMOZAINI REAL ESTATE

ACKD scope of work:

urban spaces and public Garden located in Saudi Arabia , Al-Khafji, Safaniya, 10.000 SQM

- Concept design**
- > Study project & Prepare zoning and mood boards according to the client's requirements, site forces & plot regulations, and shape
 - > Prepare a Design criteria represents all disciplines (ARCH, STR, ELEC, MECH)

- Concept design**
- ACKD works include in ARAMCO Garden Design Principals Environmental aspect :
- > Energy consuming solutions
 - > Recycled materials
 - > Waste management
 - > Minimum maintenance landscape

- Social Aspect**
- > Sport
 - > Recreation
 - > Quality of life
 - > Disabled consideration
 - > Safety

SUNSHADE
STEEL STRUCTURE SUNSHADE WITH FIXED SOLAR PANELS

PUBLIC / PLANTING
PLAYGROUND NO. 1
PLAYGROUND NO. 2
BENCH TYPE A
BENCH TYPE B
ARTIFICIAL GRASS

PATHWAYS / PARKING
INTERLOCK WALKWAYS
54 CAR PARKING
RUBBER WALKWAY
RUBBER BICYCLE PATH

STREETS
GARDEN PLOT IS SURROUNDED BY THREE 15M WIDTH STREETS



08

Surveying

[BACK TO
TABLE OF CONTENT](#)



Surveying

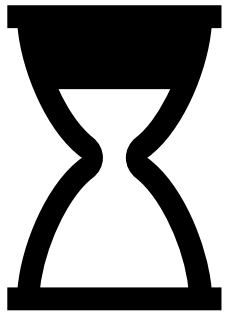

Duration: 15 Min.



Geo slam



Gps



Total station

AGENDA

- > ACKD Overview
- > Previous Projects
- > Plan Approval Process
- > Introduction to laser scanning.
- > Sample of ACKD's previous work
- > Heritage Documentation By Laser Scan.
- > Industrial sector services.
- > Light SurveyProcess



Drones

Surveying

Laser scan survey Process :

Laser scanning is a technology used to measure distances and determine locations using laser beams.

Here are the basic steps to perform laser scanning:

You will need a laser device that contains a laser source and a receiver to receive the bounced signals.

We install the device: Mount the device on a stable platform such as a tripod or a moving vehicle.

We define the scanning area: Select the area you wish to laser scan. This area can be a building, floor, city, or any other location.

We turn on the laser: turn on the device and adjust its settings according to your needs. You can adjust the polarization angle, pulse intensity, sampling rate, laser range and other settings.

We analyze the data: After collecting the data, it must be analyzed and processed using BIM programs in order to create two-dimensional maps, horizontal projections, and a 3D model. On the BIM system



Surveying

Sample of the previous projects:

1_SAUDI HOSPITALITY COMPANY (SHC)



- > Scope of Services
As-Built: Architecture, Civil & MEP WITH LASER SCAN
LE MERIDIEN EL HADA HOTEL

2_The RITZ CARLTON Hotel. (survey project).



- > Scope of Services
As-Built: Architecture & MEP

THANK YOU

CONTACT INFO

ACKD scope of work

Website www.ackdconsult.com

Email info@Ackdconsult.net

Phone +966 56 666 0960
011 2167333

Riyadh, Saudi Arabia

Prince Mohammed Ibn Salman Ibn Abdulaziz Rd

First Floor - Office 20

www.ackdconsult.com

Riyadh, Saudi Arabia

The logo for ACKD, featuring the letters A, C, K, and D in a stylized, white, outlined font. The 'A' is a simple triangle, the 'C' is a partial circle, the 'K' is a simple shape, and the 'D' is a simple shape.

Assuring Codes & Keen Design